

**MOULD
KING**

®

宇星军事系列
MILITARY NO.T-34

宇 | 星 | 模 | 王



20015 | 8+
年齡
Ages/Edades

OPEN

Customer Service
客户服务  www.yx-mk.com



酷砖家系列是宇星设立的全新子品牌/系列，本系列所有套装均由国内外顶级设计师操刀设计或授权，旨在为消费者带来高水准的积木设计套装和与众不同的拼搭体验。

BriXpert series is a new sub-brand/series set up by Mould King. Models of this series are all designed or authorized by top designers/MOCers around the world, aiming at bringing consumers with high-level brick sets and a unique building experience.

广东宇星科技

微信扫描二维码，关注公众号。
获取第一手的新品资讯，享受便捷的补件服务。



Qr code APP (APP二维码)

Need the apple version 9.0 and above, the android version 5.0 and above.

* This APP supports most of the mainstream Android models on the market, but due to the large number of Android models, different models of systems and hardware reasons, there may be some models do not support, specific according to the actual level!





T-34坦克是一款苏联于二战前研发的中型坦克是二战中产量最大的坦克,同时也是二战期间同苏联钢铁洪流的主要组成部分。

The T-34 tank is a medium-sized tank developed by the Soviet Union before World War II. It was the largest tank in World War II, and also the main component of the steel flood with the Soviet Union during World War II.



T-34坦克是在1937-1940年开始由哈尔科夫莫洛佐夫机械设计局研发, 在1940年开始生产, 直到1958年停产为止共生产84070辆。

T-34 tanks were developed by Kharkov Molozov Mechanical Design Bureau from 1937 to 1940, and began to be produced in 1940. A total of 84070 tanks were produced until 1958.

T-34坦克被誉为“传奇坦克”。参加过第二次世界大战, 朝鲜战争, 越南战争, 南斯拉夫战争, 利比亚战争, 1979-对越南自卫反击战以及对第三次中东战争等各大战争。

T-34 tank is known as "legendary tank". Participated in the Second World War, the Korean War, the Vietnam War, the Yugoslav War, the Libyan War, the 1979 Self defense and Counterattack War against Vietnam, the Third Middle East War and other major wars.

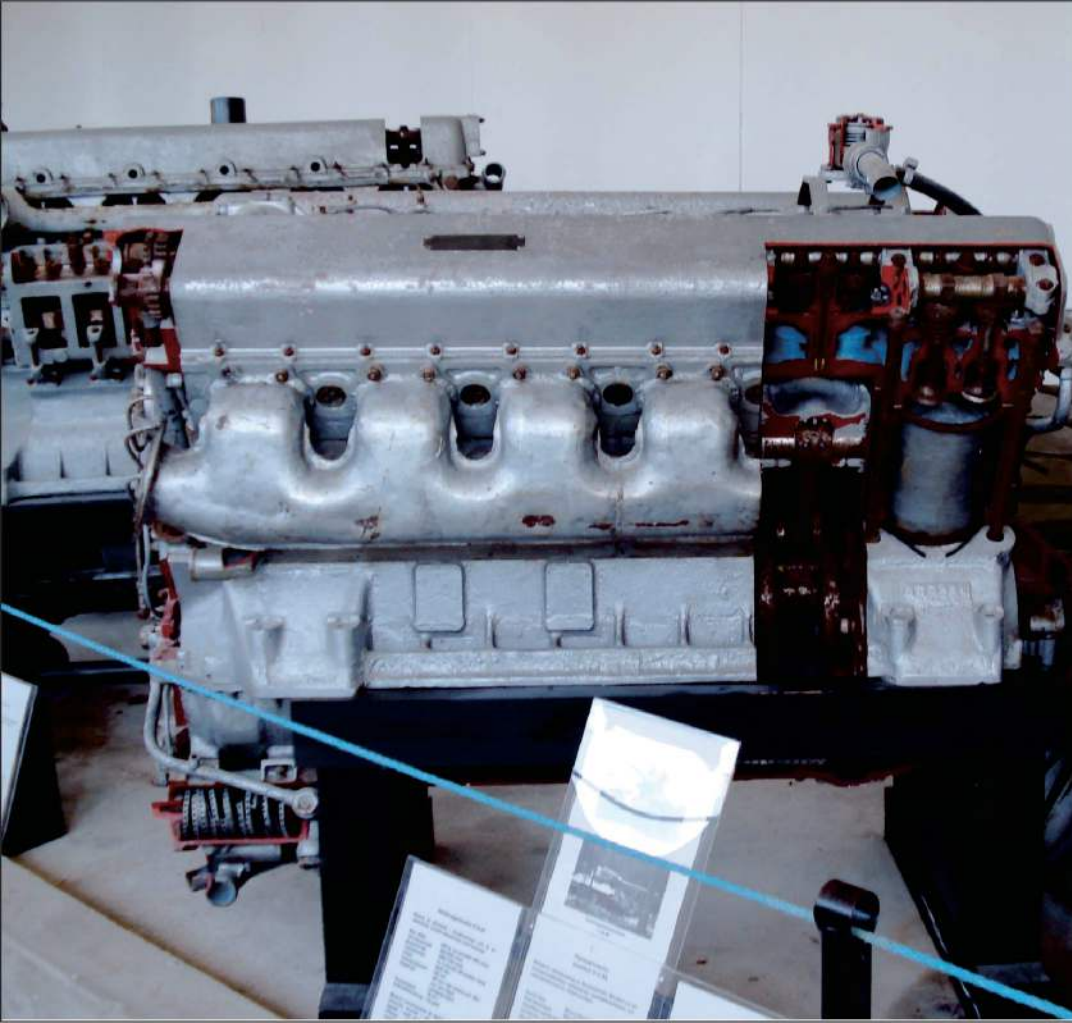

T-34坦克全重32吨,长6.1米,宽2.9米。发动机功率500马力,最大公路速度75千米/小时,最大行程400千米,装备一门76毫米坦克炮,是一型火力、防护力和机动性都很突出的坦克。其型号主要为两种:安装76.2毫米坦克炮的T-34/76坦克和安装85毫米坦克炮的T-34/85坦克。T-34坦克带有倾斜装甲的设计思路对后世的坦克发展有着深远及革命性的影响。

The T-34 tank weighs 32 tons, is 6.1 meters long and 2.9 meters wide. The engine power is 500 horsepower, the maximum road speed is 75 km/h, the maximum travel is 400 km, and it is equipped with a 76 mm tank gun. It is a tank with outstanding firepower, protection and mobility. There are mainly two types: T-34/76 tank with 76.2mm tank gun and T-34/85 tank with 85mm tank gun. The design idea of T-34 tank with inclined armor has far-reaching and revolutionary influence on the development of tanks in later generations.

苏联设计师莫罗佐夫特地为T-34研制了著名的12缸39升V-2柴油发动机，功率500马力，使其公路最高时速达到55千米/小时。V-2柴油机的体积为1.87立方米，整个马达部分体积为4.4立方米，其发动机辅助设备和散热器布置较为紧凑。V-2柴油发动机的另一个优点是省油，T-34坦克油箱容量460升，车身两边各挂一个容量39升的后备油箱，行程可达540千米。

The Soviet designer Morozov specially developed the famous 12 cylinder 39 liter V-2 diesel engine for T-34, which has a power of 500 horsepower, making its maximum road speed reach 55 km/h. The volume of V-2 diesel engine is 1.87 cubic meters, and the volume of the whole motor is 4.4 cubic meters. The layout of engine auxiliary equipment and radiator is relatively compact. Another advantage of the V-2 diesel engine is fuel saving. The T-34 tank has a fuel tank capacity of 460 liters, and a 39 liter backup fuel tank is mounted on both sides of the body, with a travel of 540 kilometers.



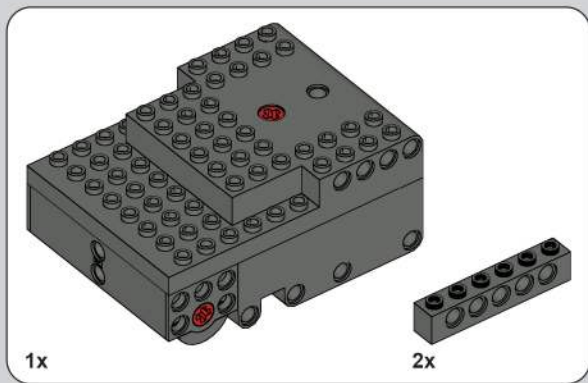
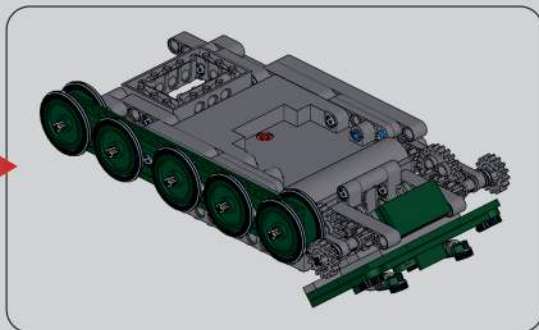

1

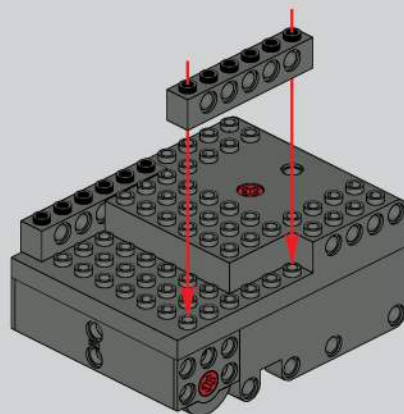

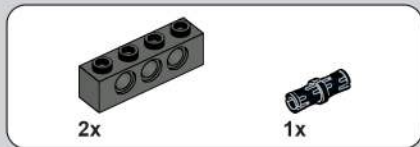

2

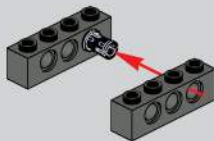

3

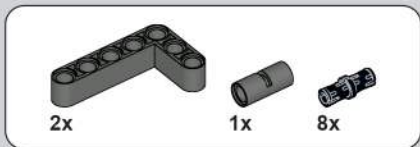

4

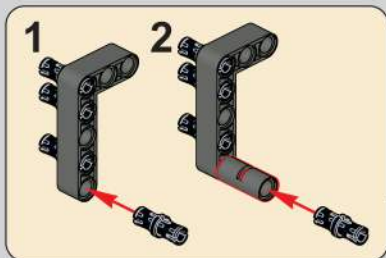

2

1

2

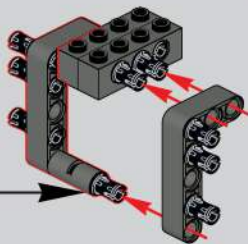

5

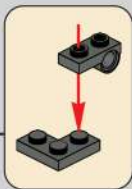
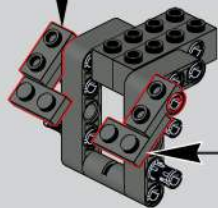
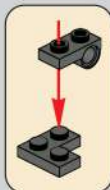

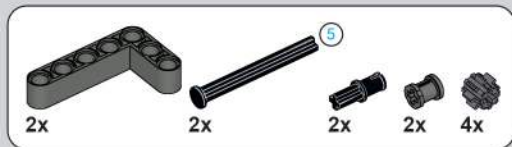

6

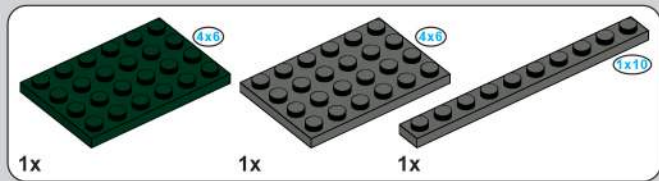
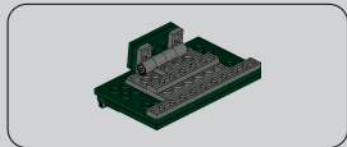
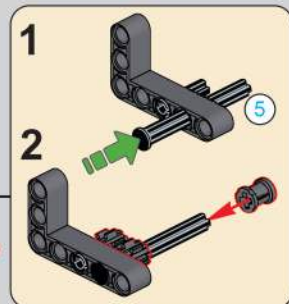
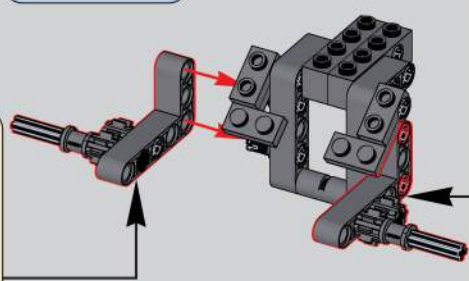
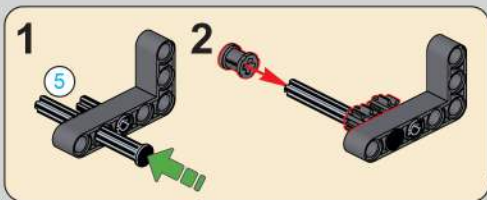

7

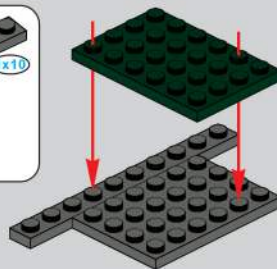

8

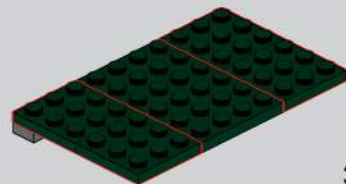

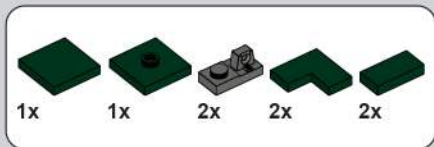

9

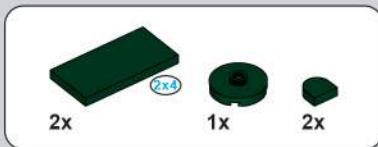
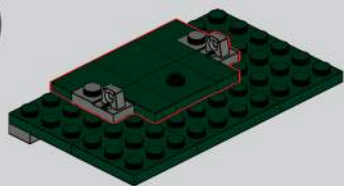

10

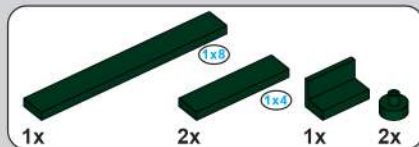
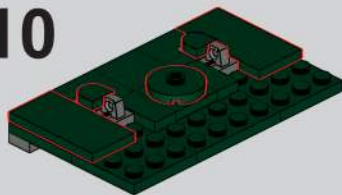

11

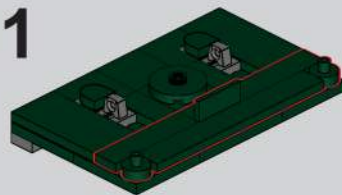

12

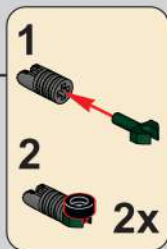
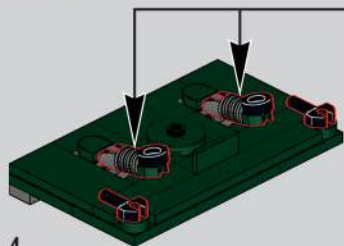

13

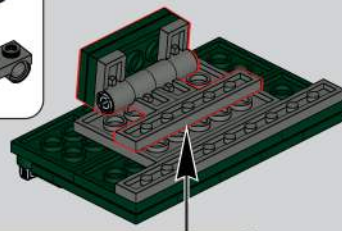
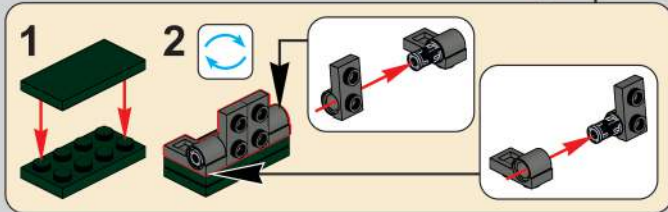
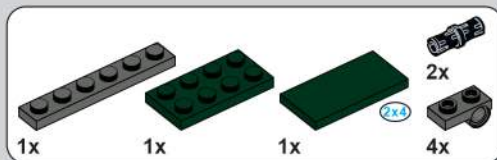

14

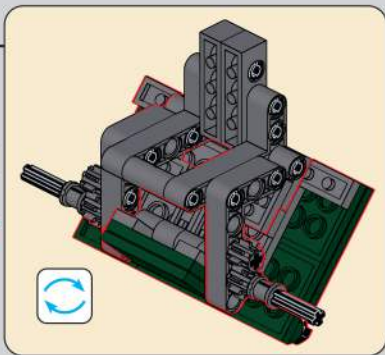
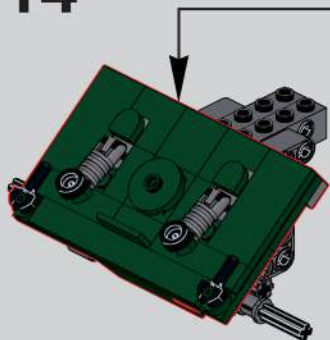

15

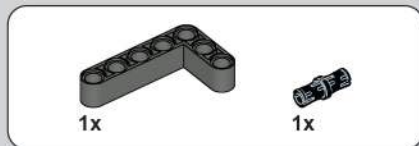
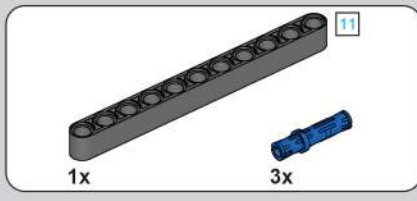
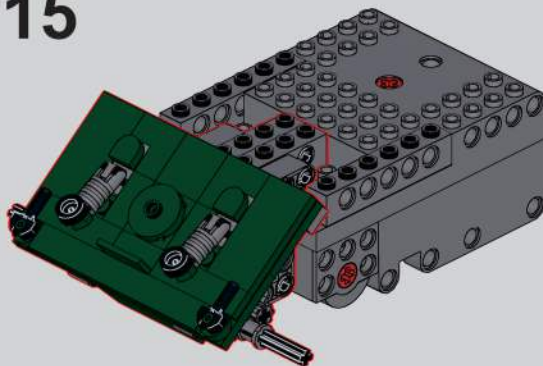

16

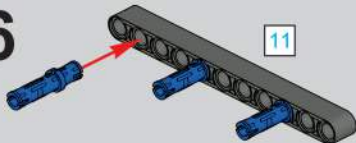

17

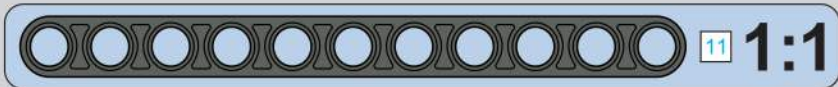
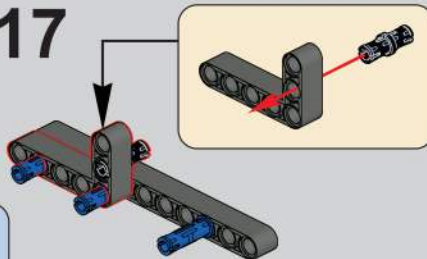

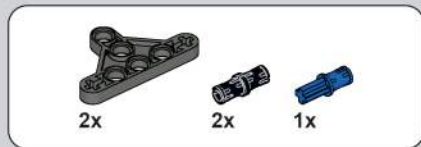

18

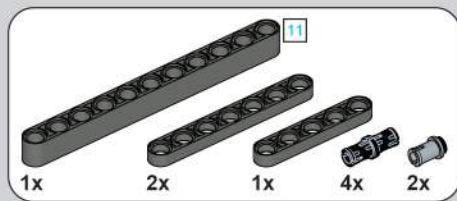
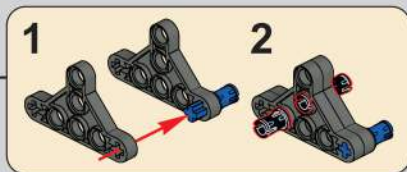
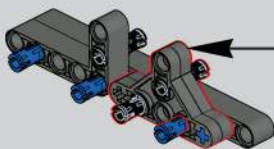

19

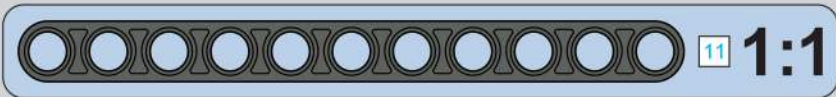
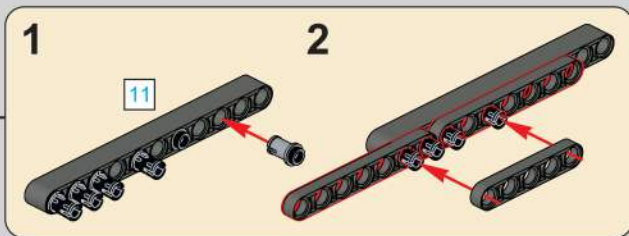
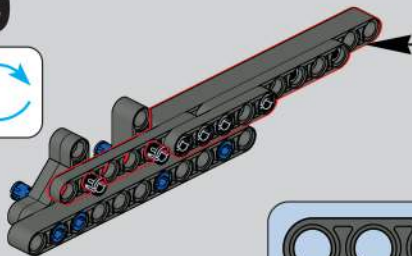

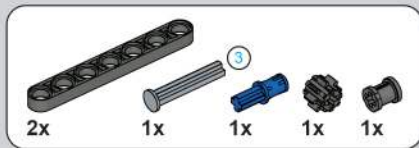

20

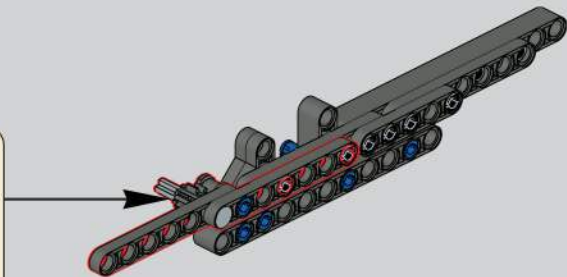
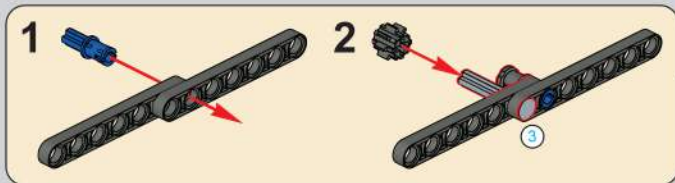

21

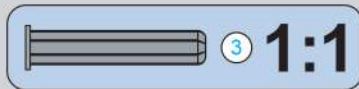
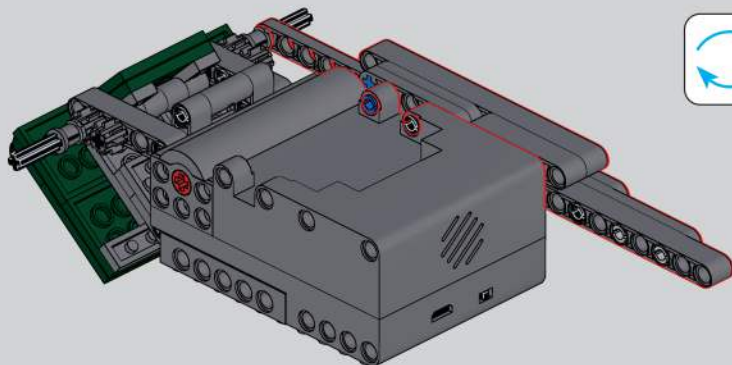

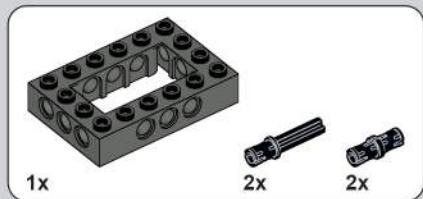
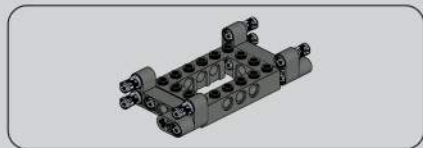

22

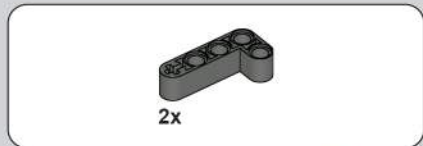

23

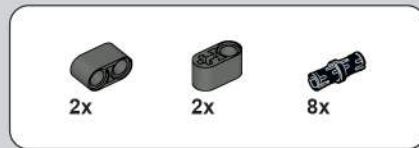
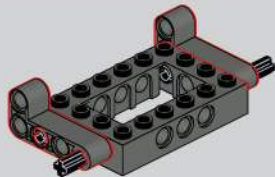

24

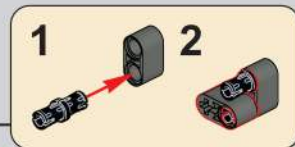
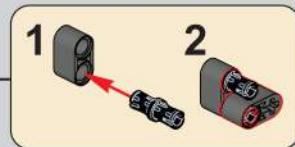
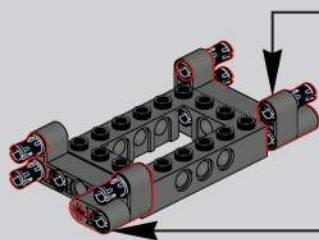

25

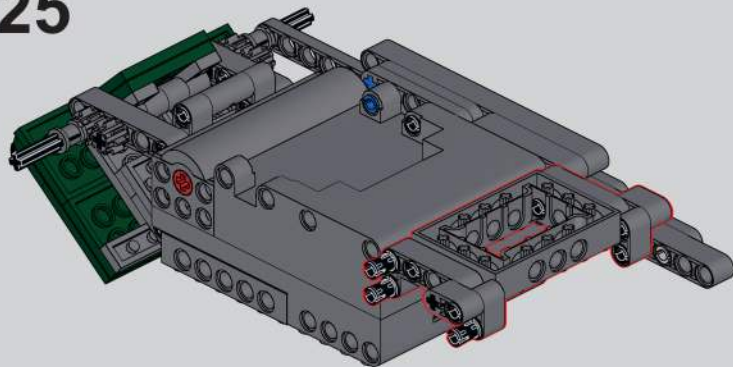

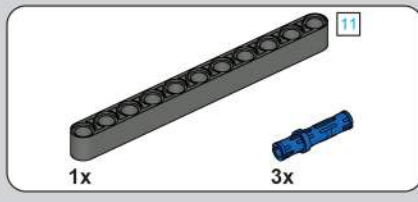

26

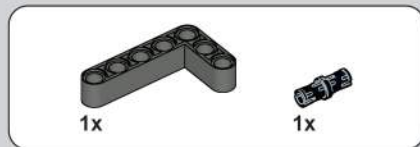

27

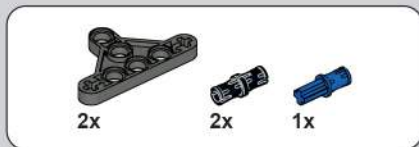
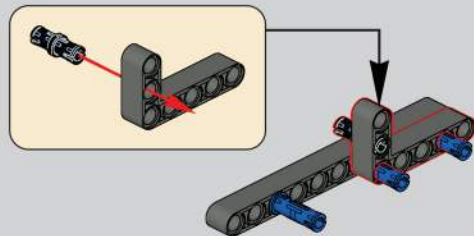
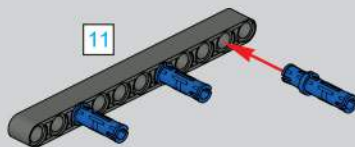

28

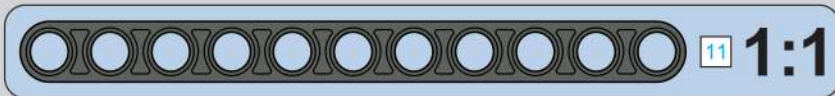
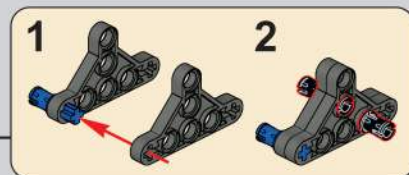
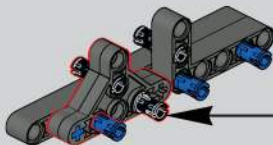

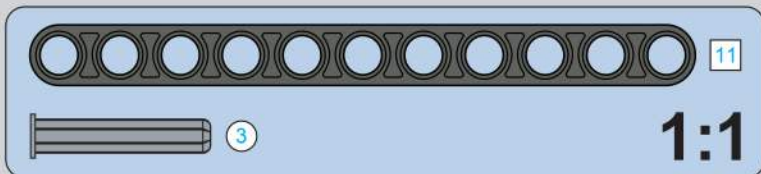
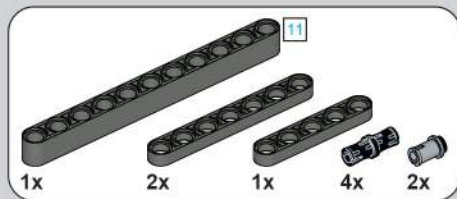

29

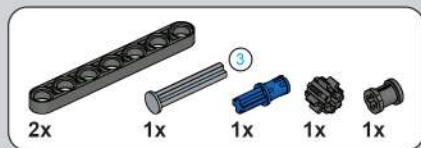
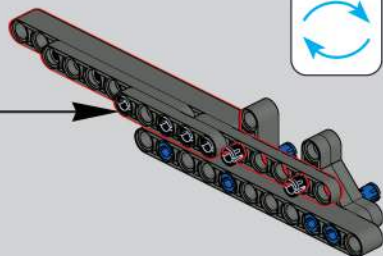
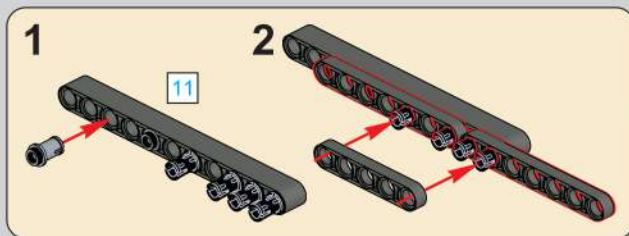

30

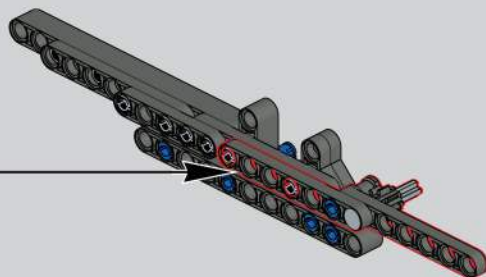
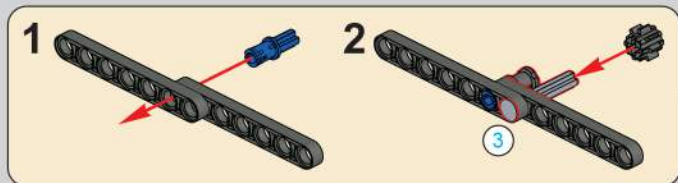

31

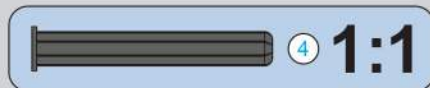
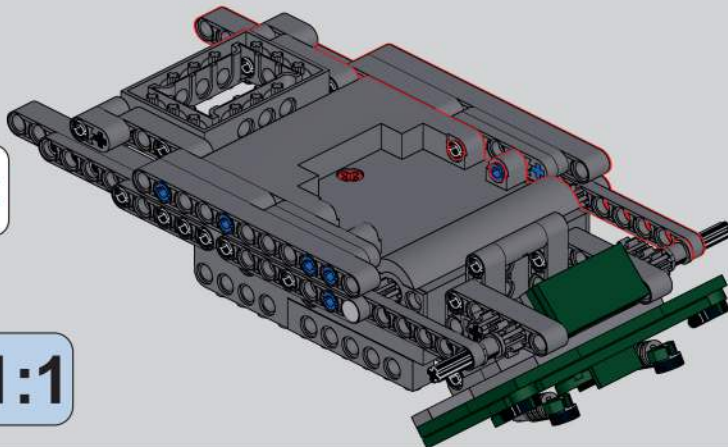

32

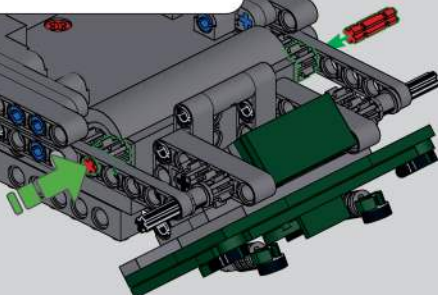

33

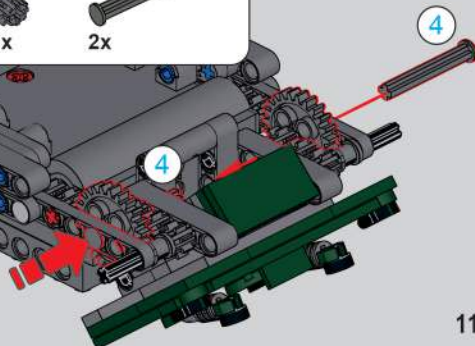



2x



2x



2x

34

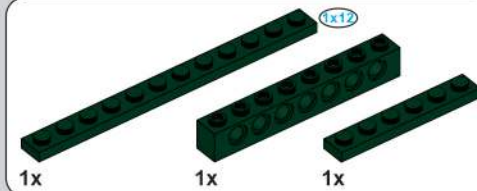
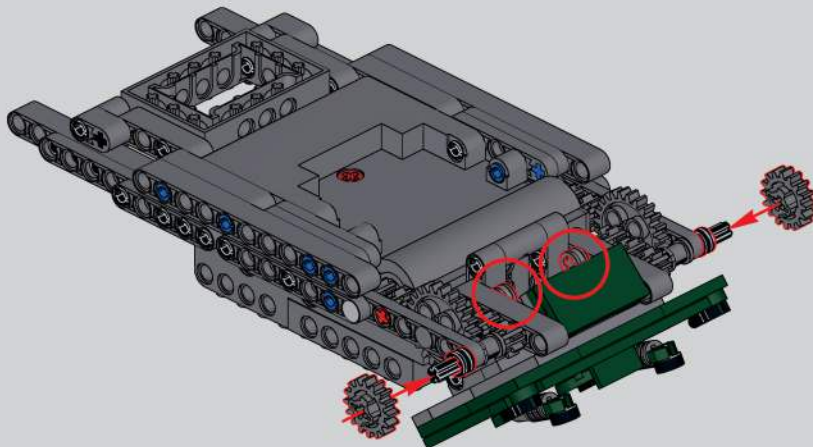

35

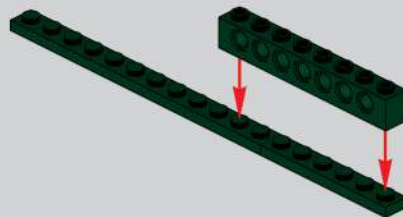

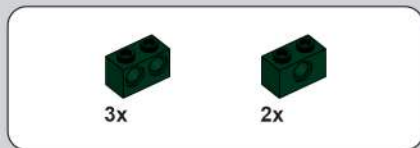

36

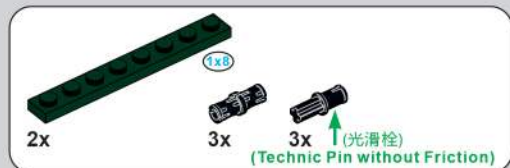

37

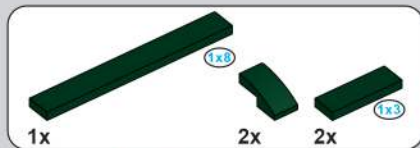
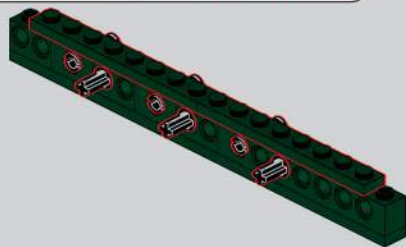

38

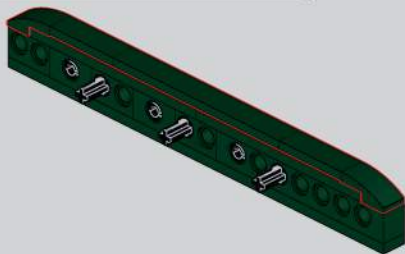

39

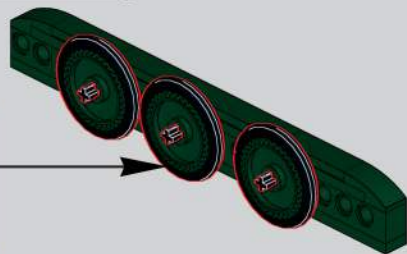
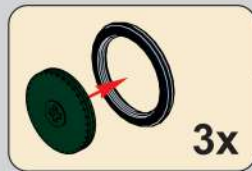

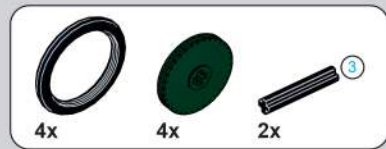

40

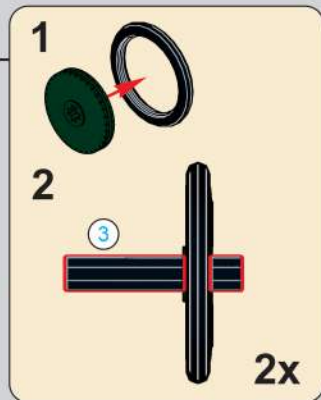
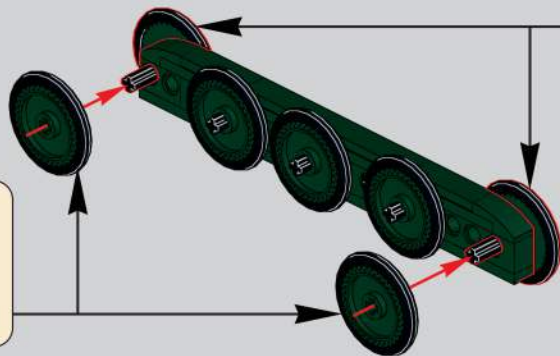
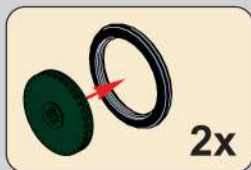

41

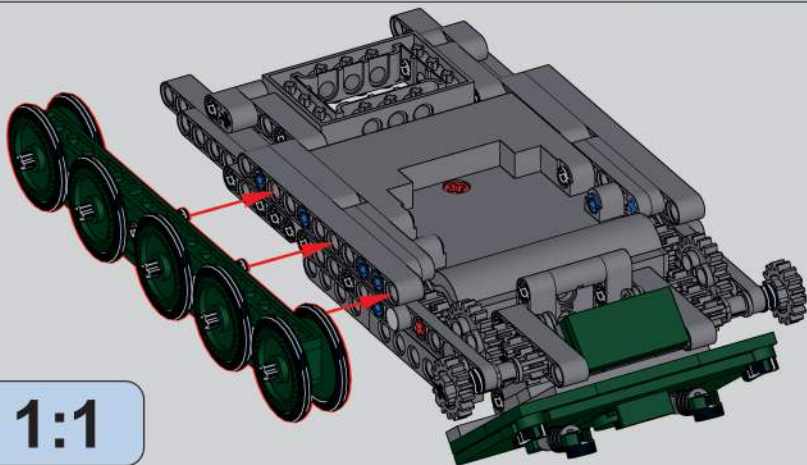

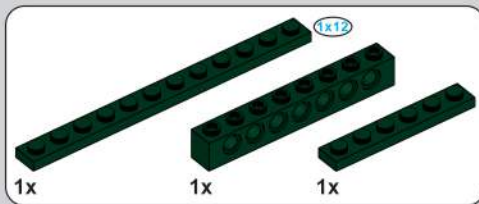
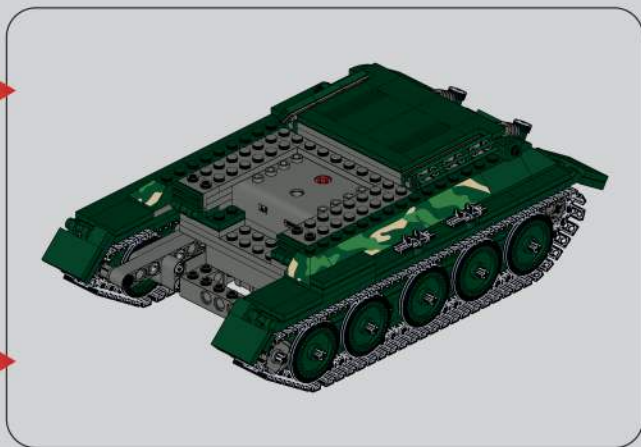

42

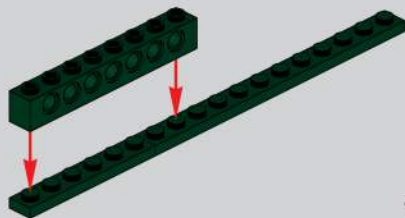



43

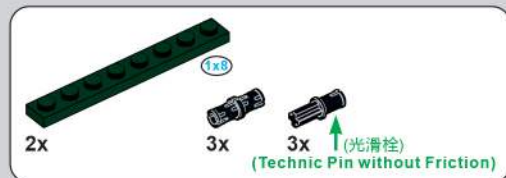
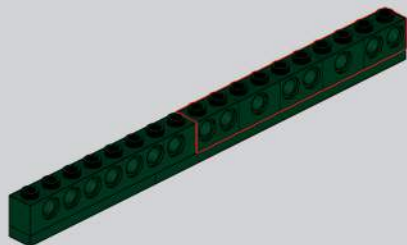

44

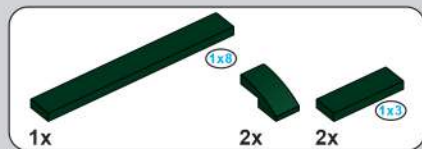
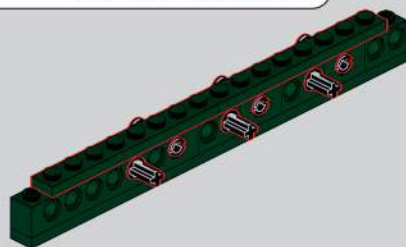

45

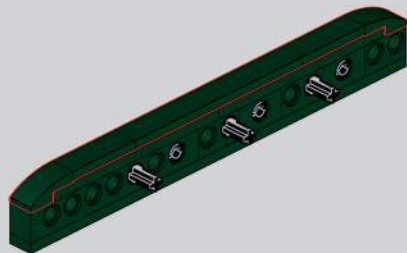

46

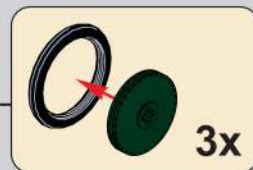
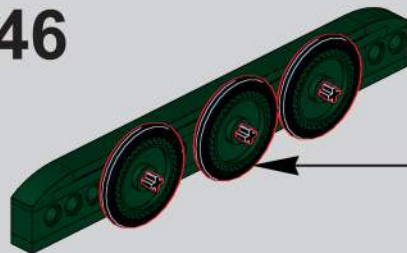



47

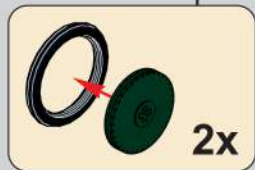
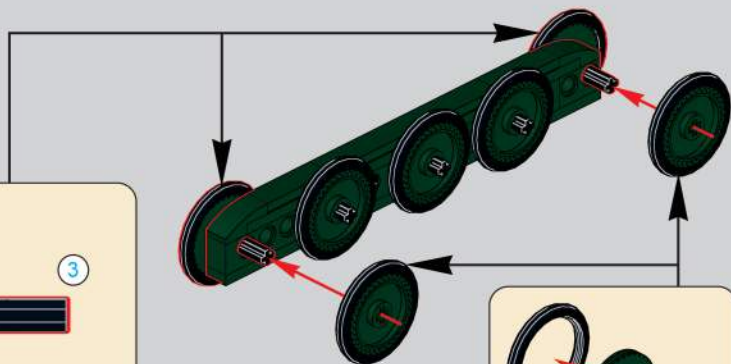
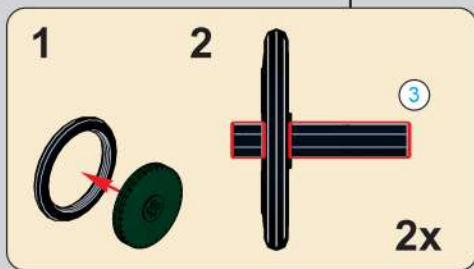

48

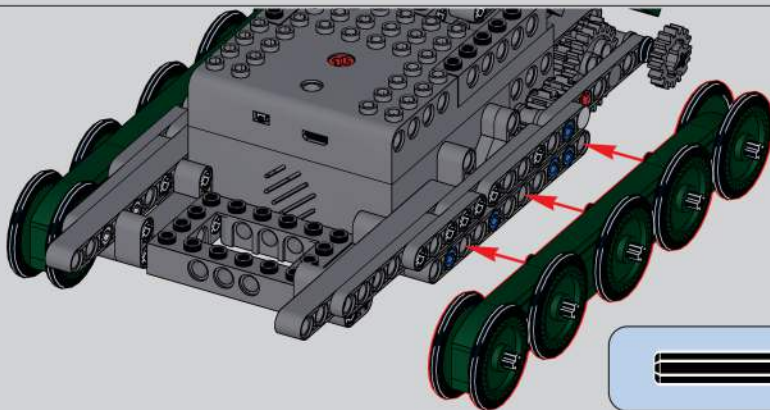

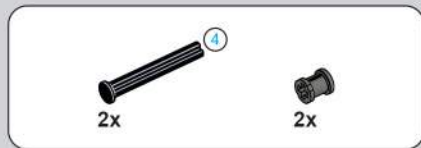

49

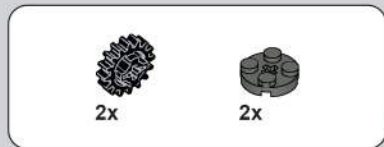
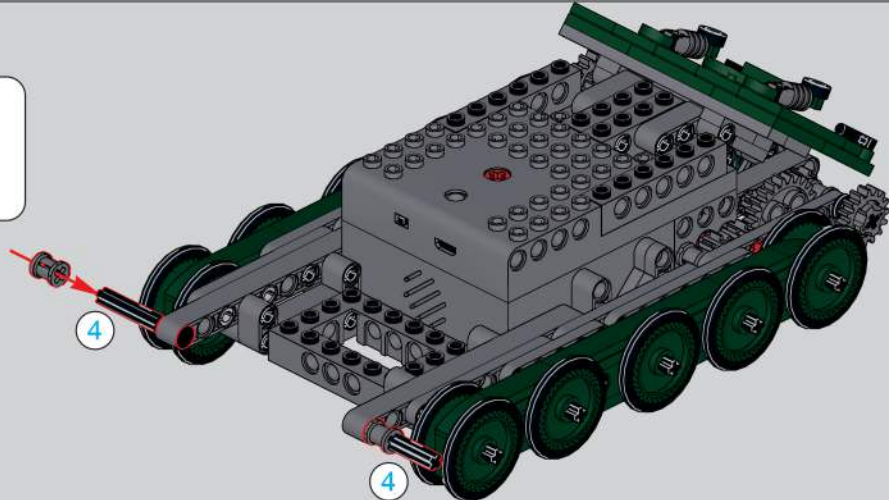

50

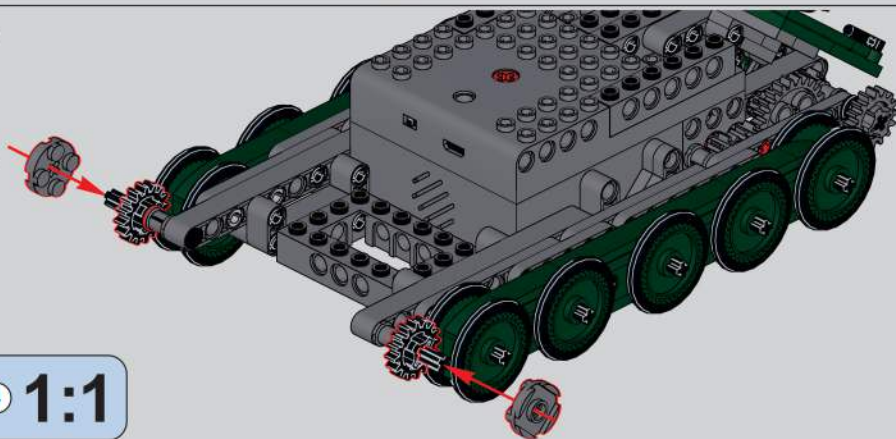

18





128x

51

64x

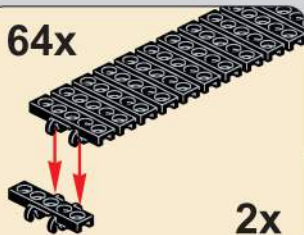

2x

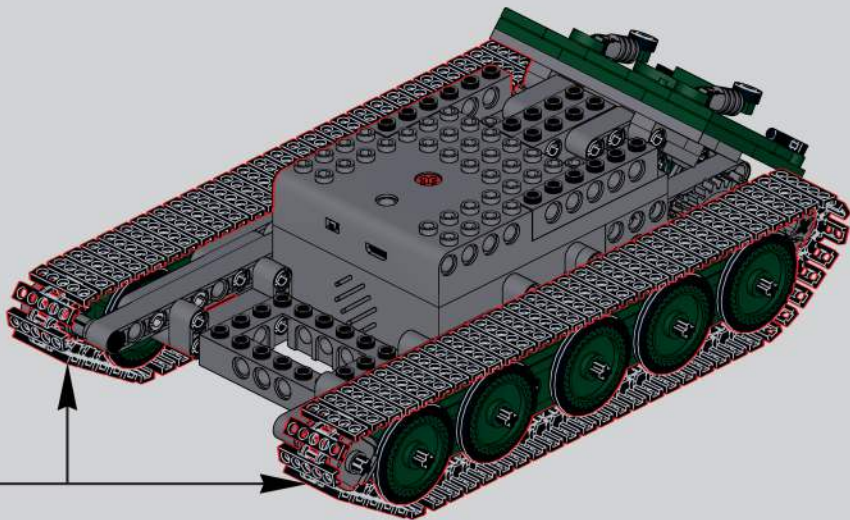

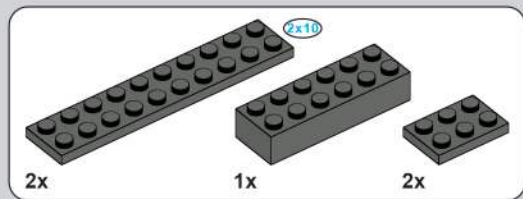

52

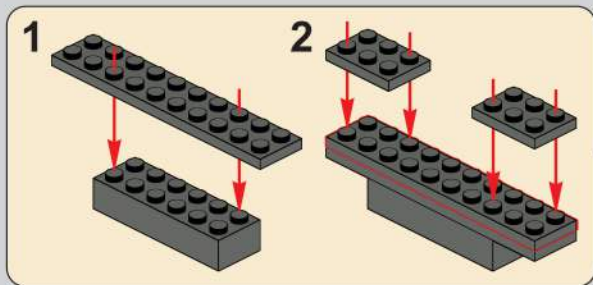
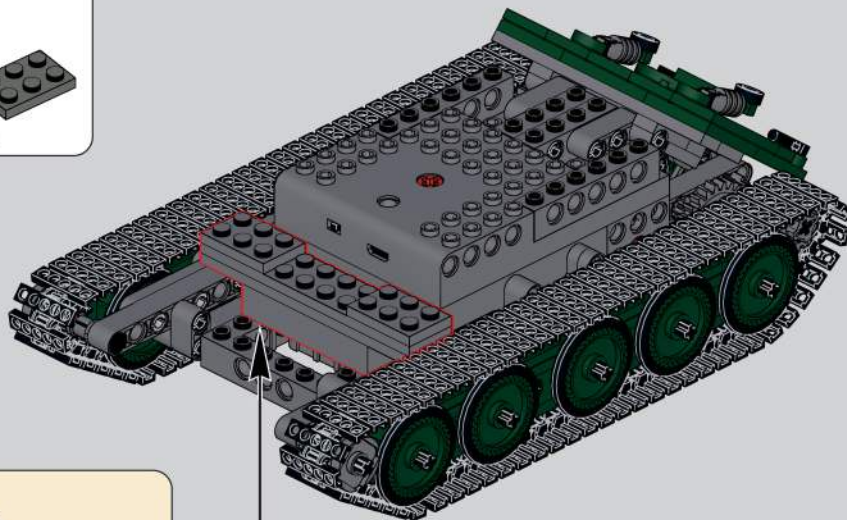

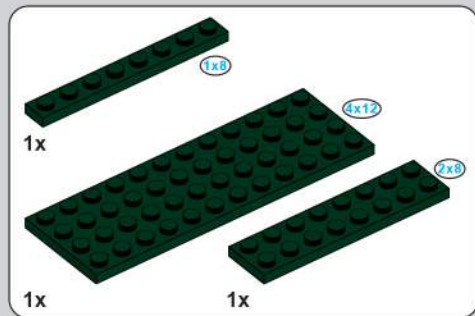
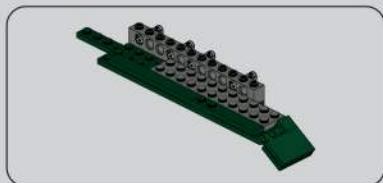

53

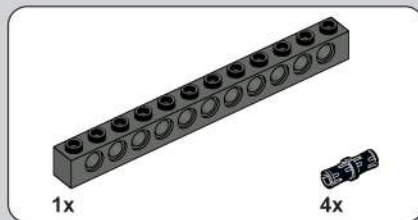
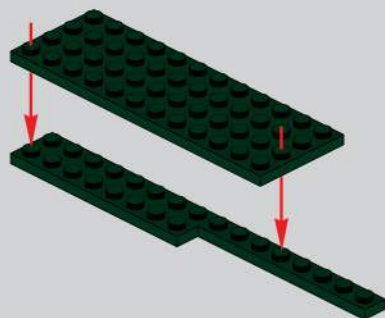

54

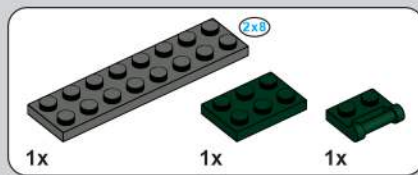
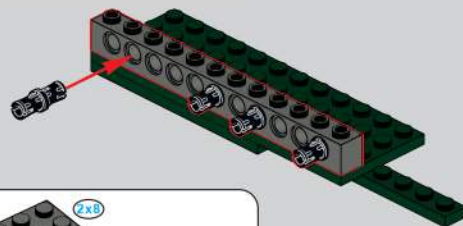

55

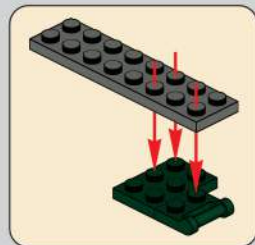
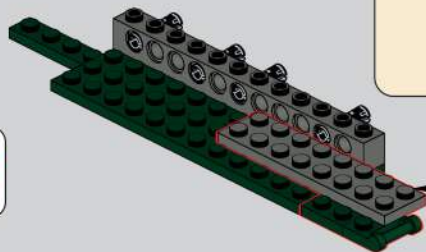

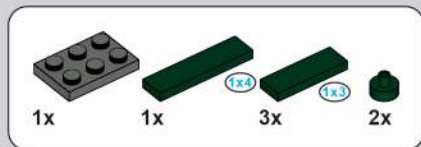

56

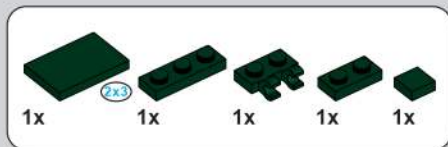
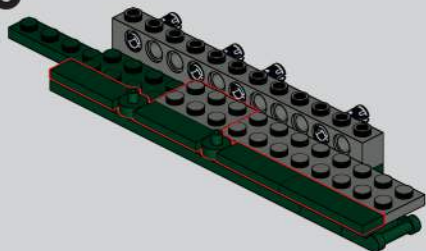

57

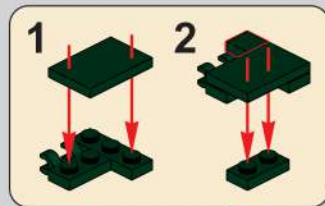
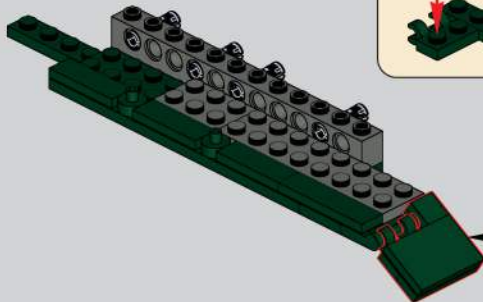

58

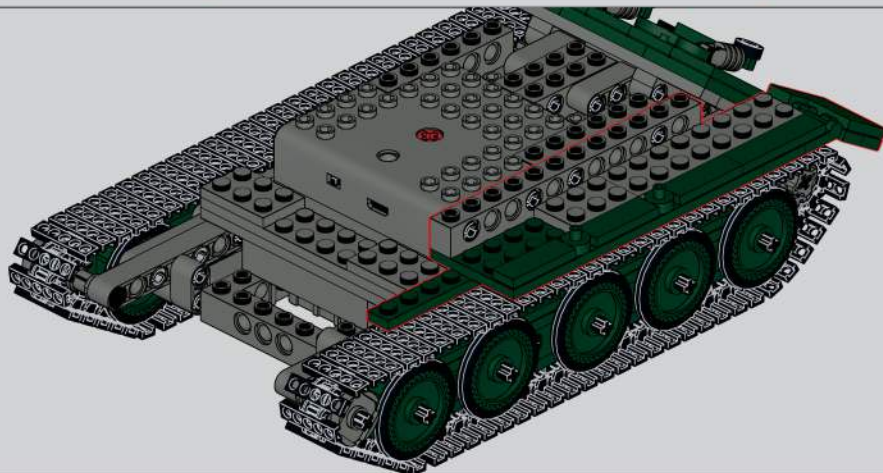

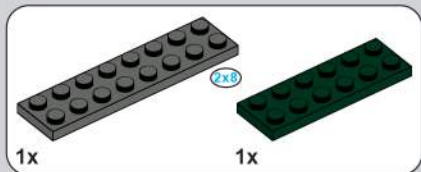
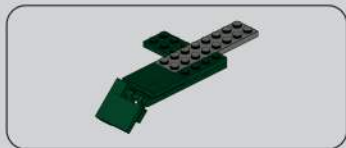

59

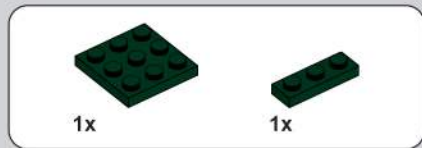
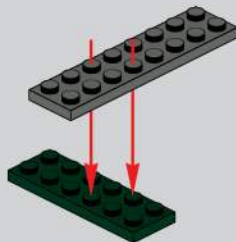

60

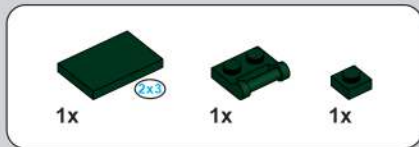
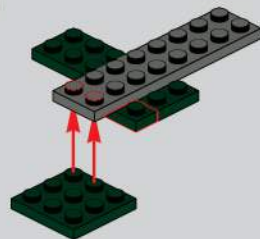

61

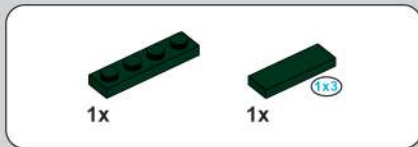
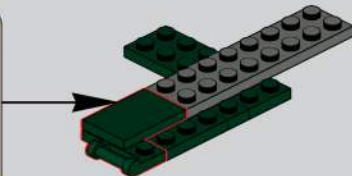
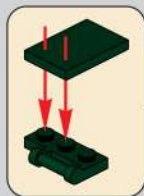

62

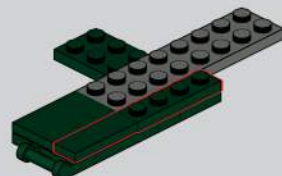

64

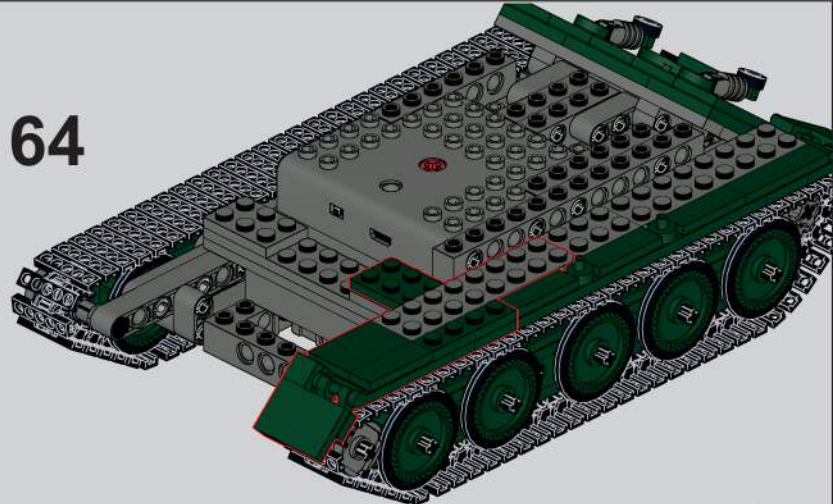

63

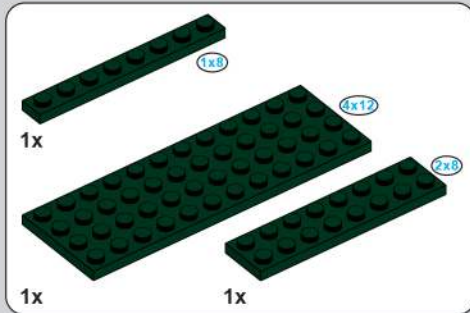
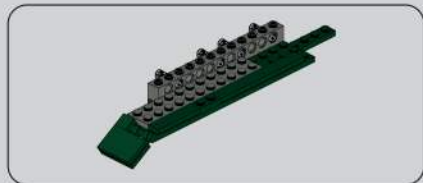
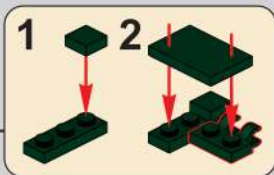
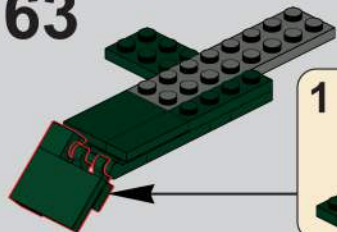

65

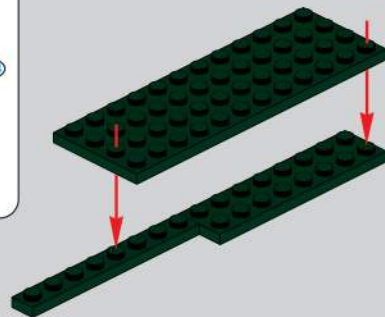

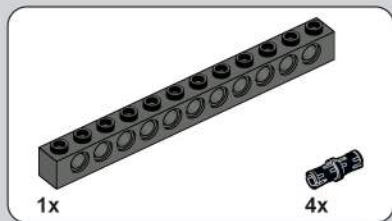

66

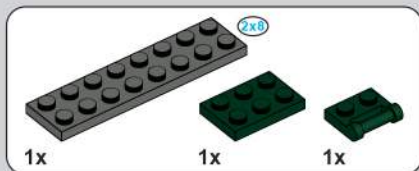
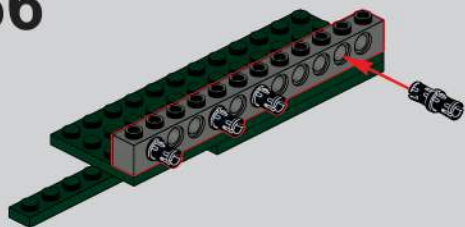

67

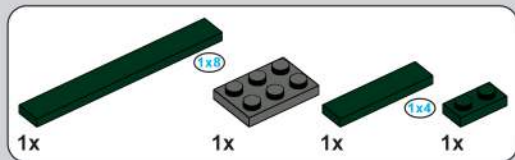
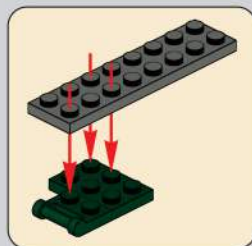
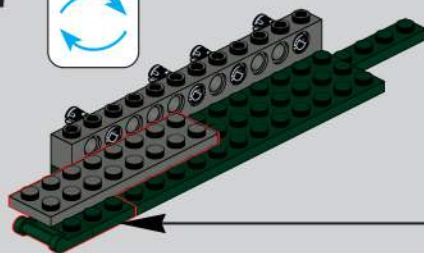

68

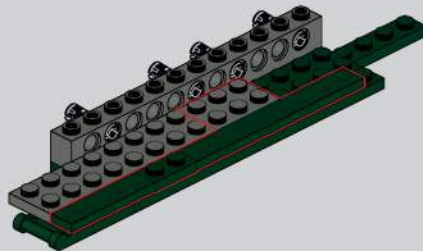

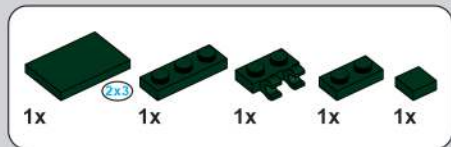

69

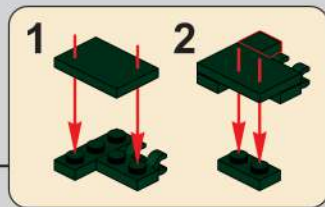
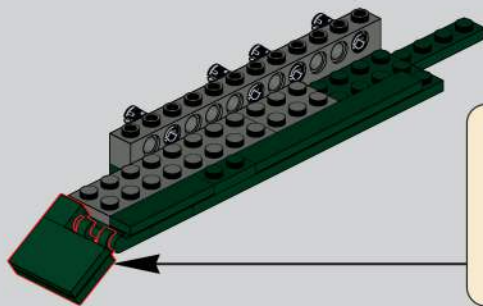

70

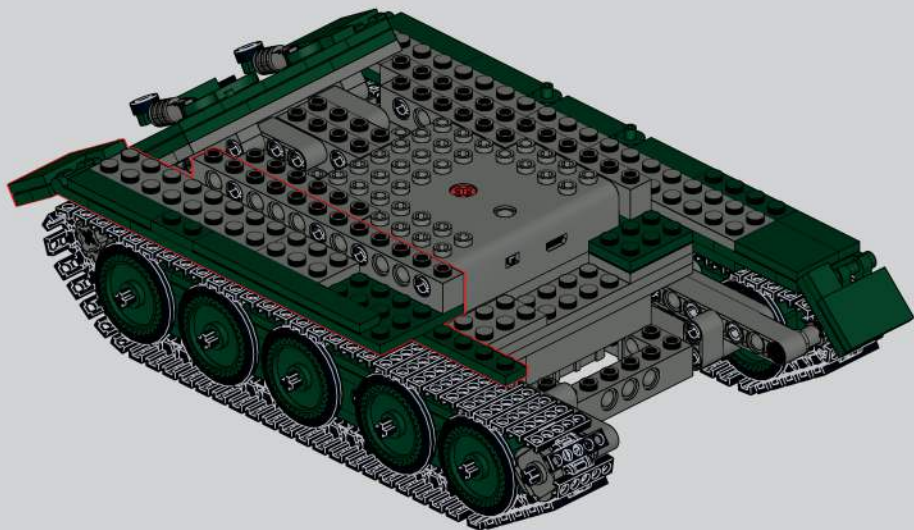

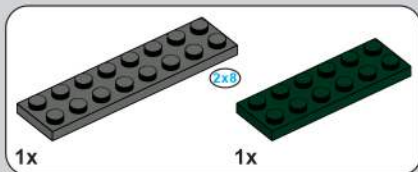
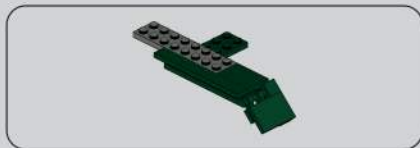

71

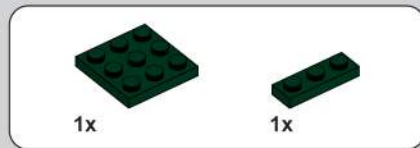
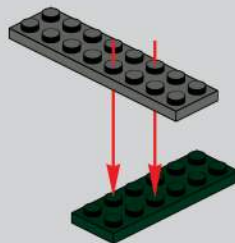

72

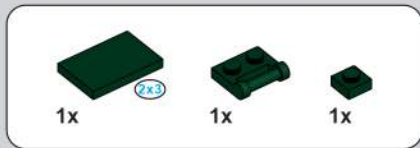
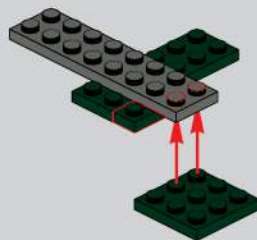

73

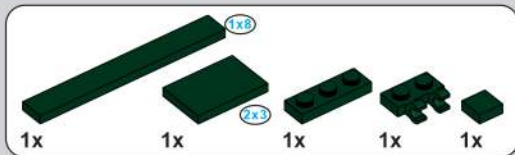
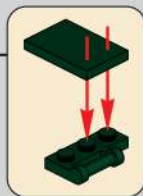
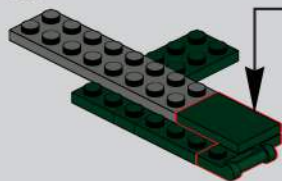

74

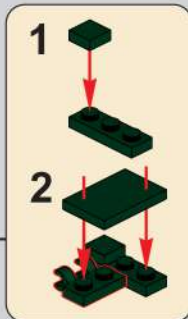
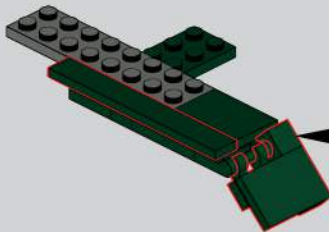

75

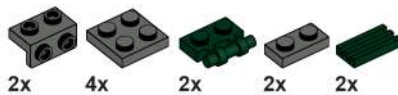
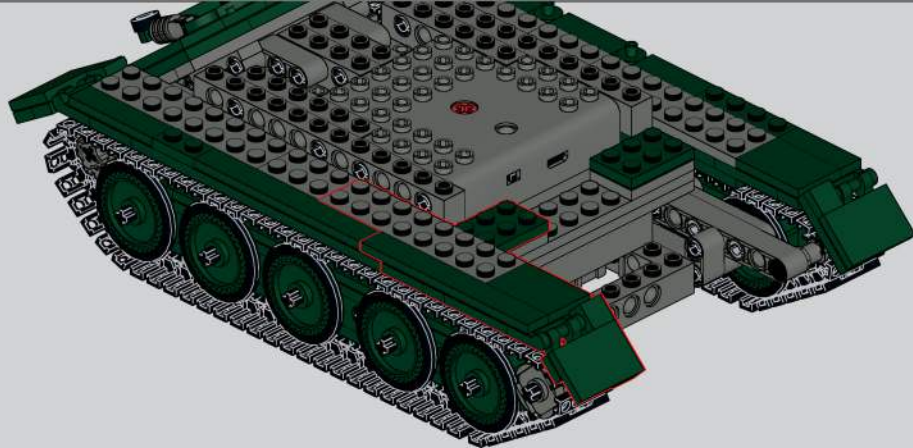

76

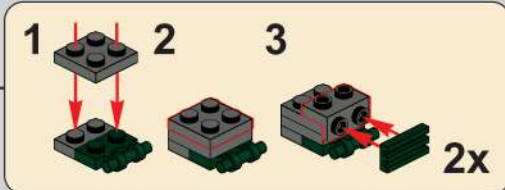
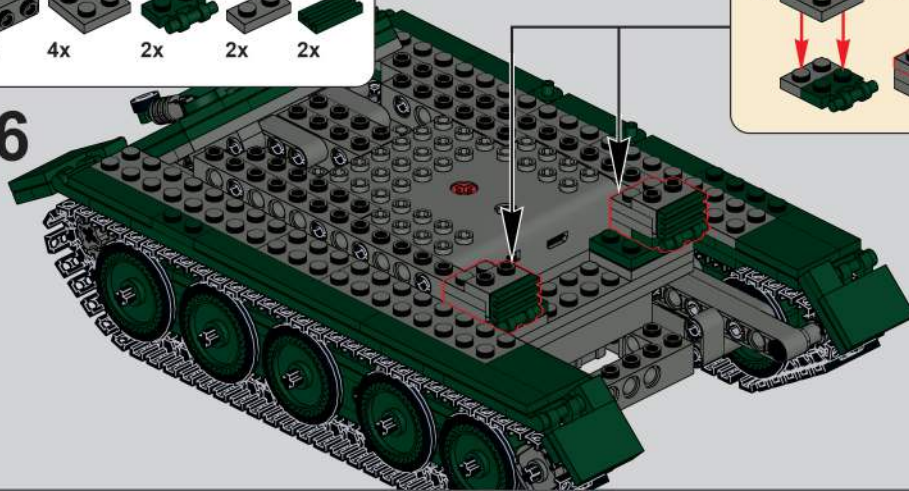

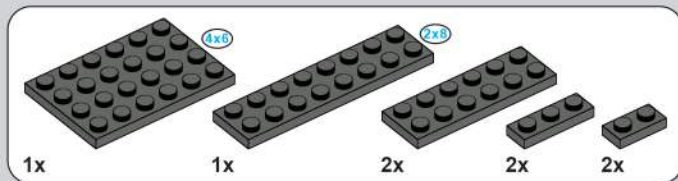

77

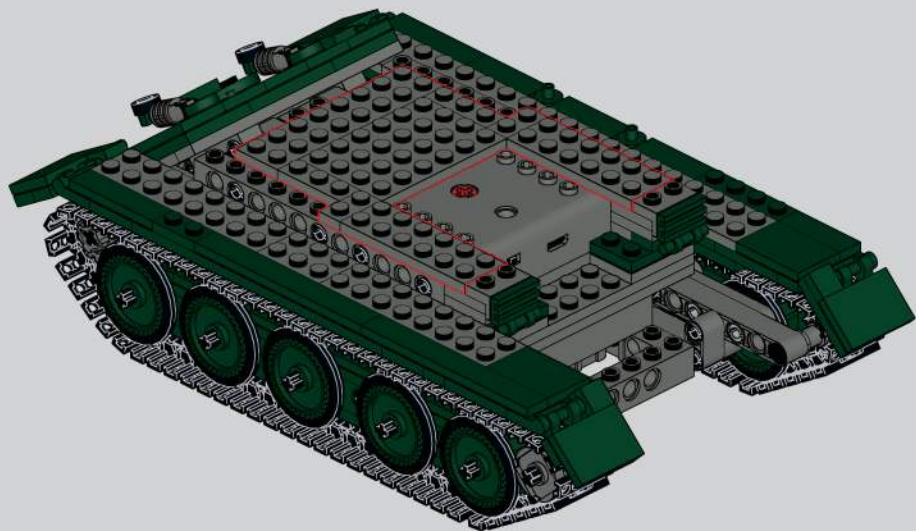

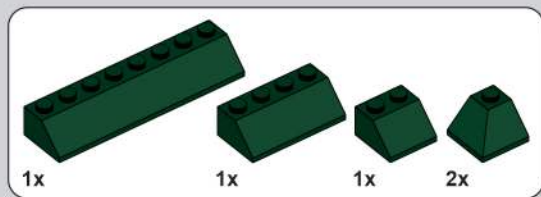

78

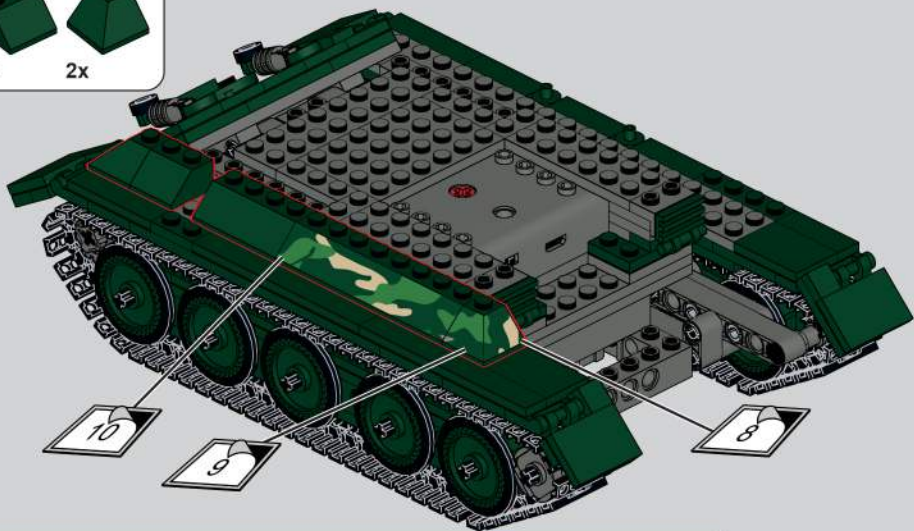

此贴纸为热感压标贴纸，不可重复粘贴

This sticker is a thermal pressure label sticker and cannot be pasted repeatedly

贴纸使用方法：撕起贴纸，对准位置随后均匀刮动，撕掉透明膜即可。

How to use the sticker: Tear off the sticker, align the position and then scrape it evenly, tear off the transparent film.

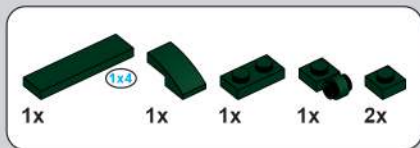

79

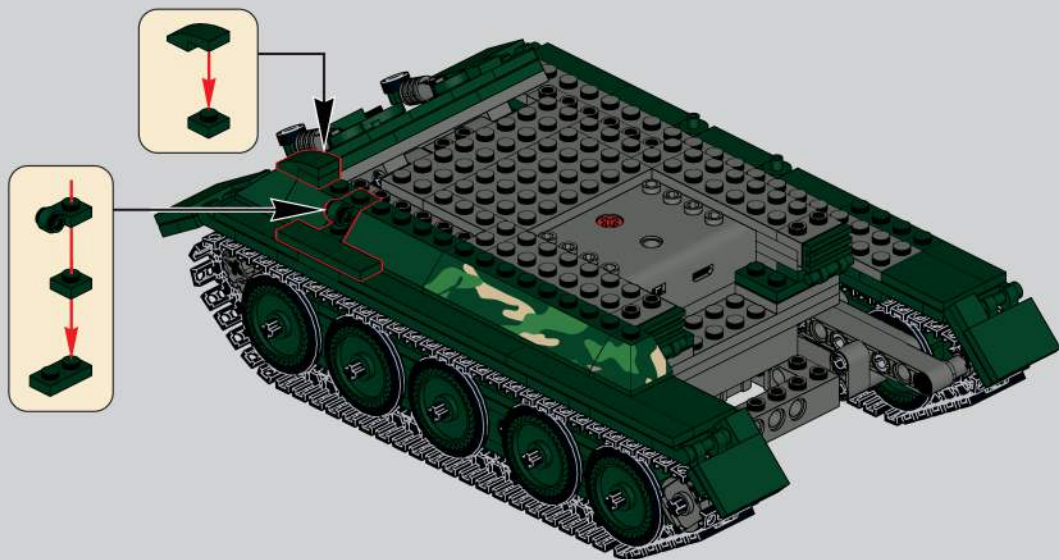

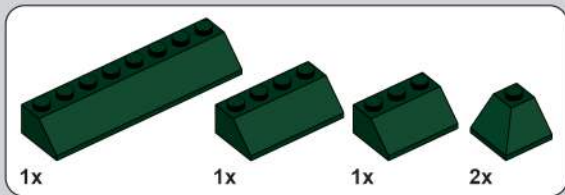

80

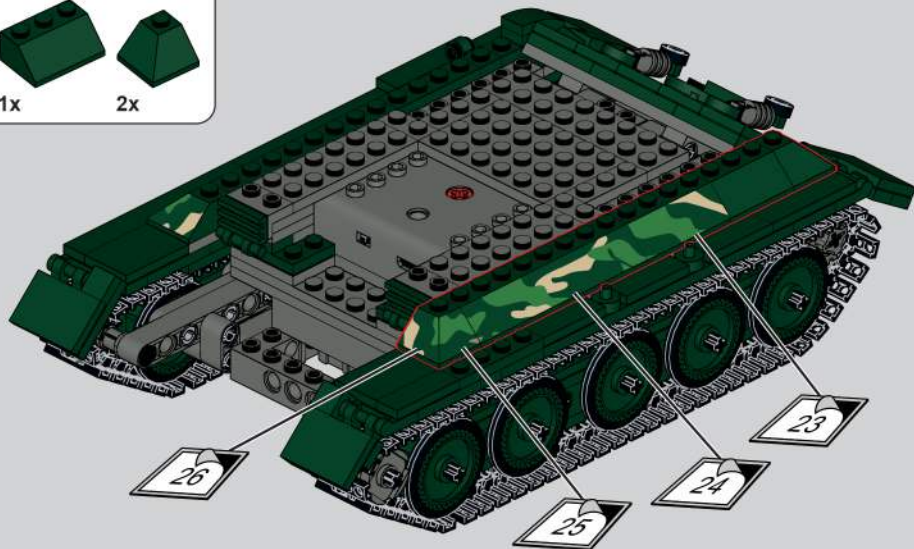

此贴纸为热感压标贴纸，不可重复粘贴

This sticker is a thermal pressure label sticker and cannot be pasted repeatedly

贴纸使用方法：撕起贴纸，对准位置随后均匀刮动，撕掉透明膜即可。

How to use the sticker: Tear off the sticker, align the position and then scrape it evenly, tear off the transparent film.

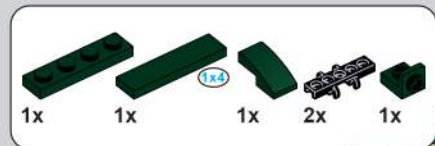

81

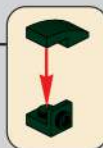
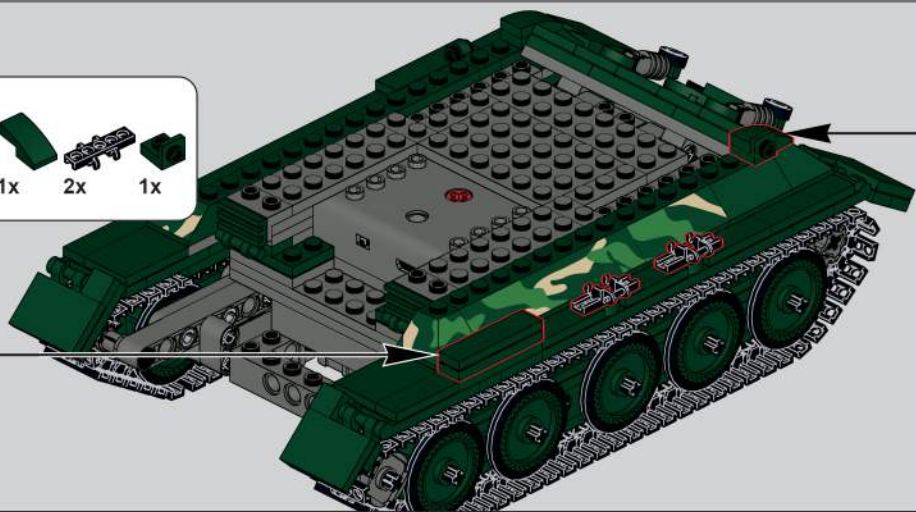
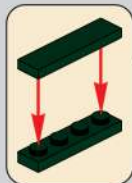

82

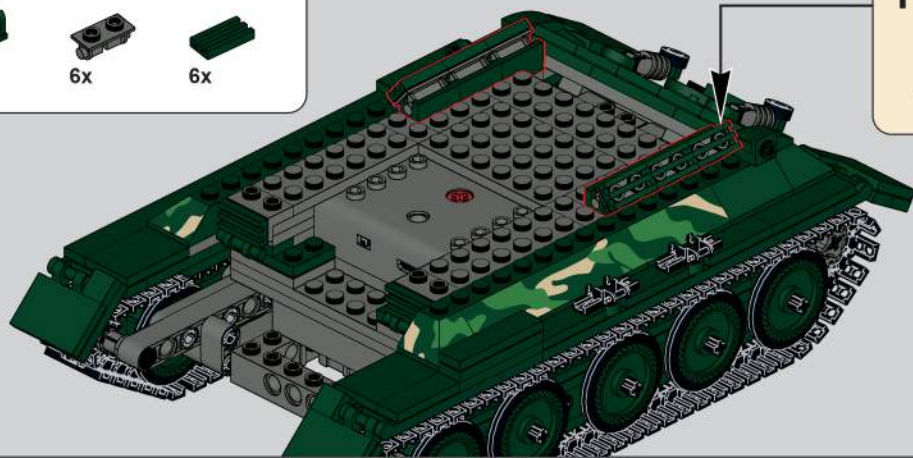
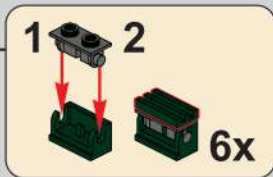

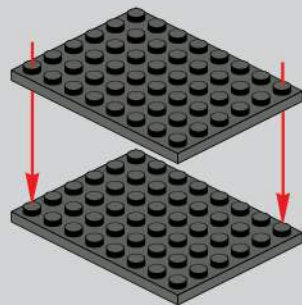
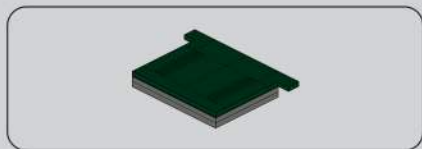

83

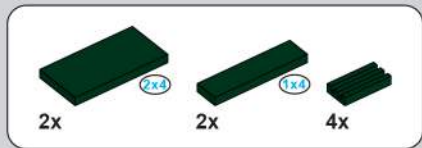

84

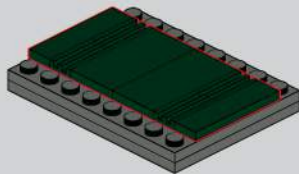

34

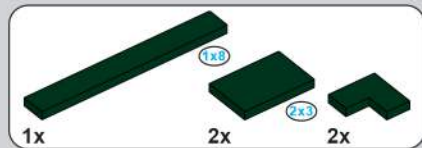

85

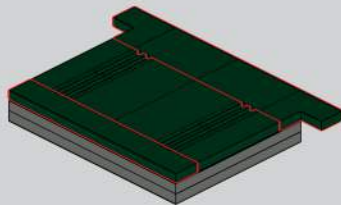

86

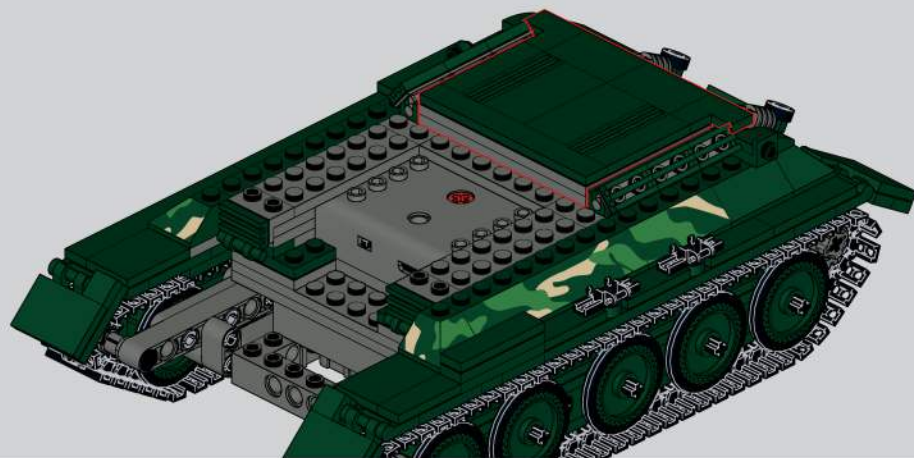

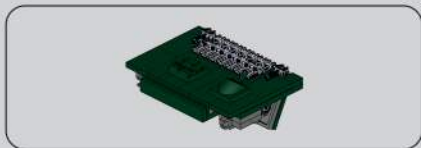

87

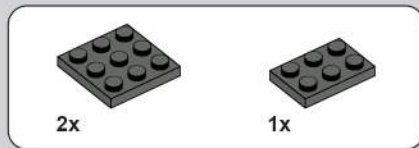
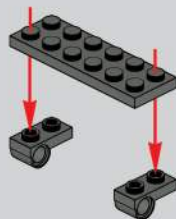

88

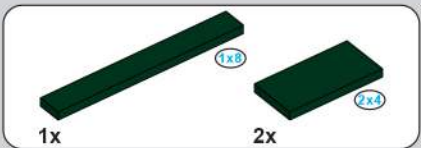
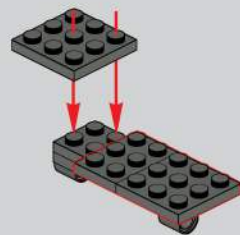

89

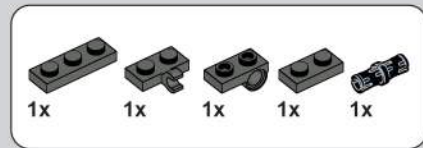
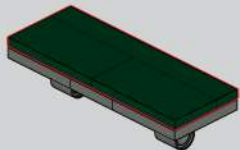

90

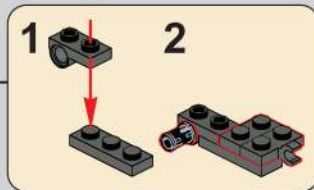
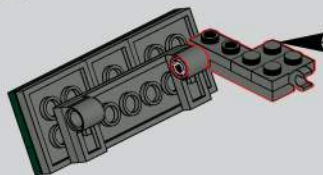

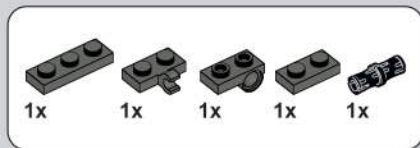

91

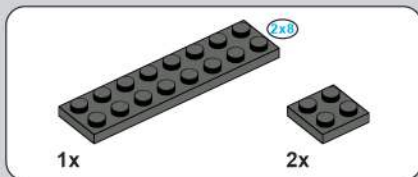
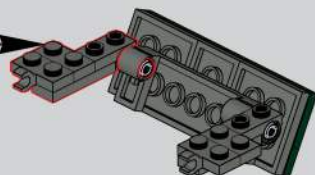
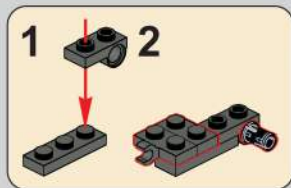

92

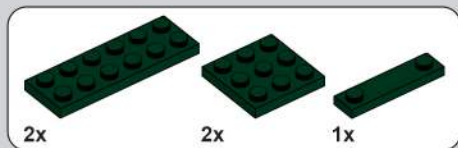
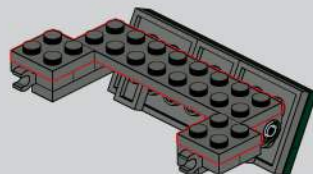

93

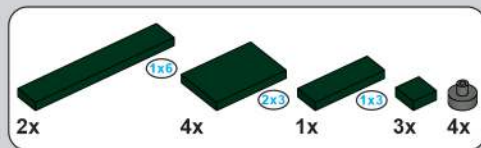
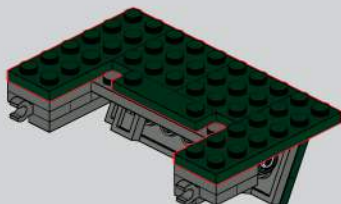

94

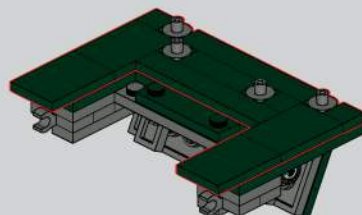

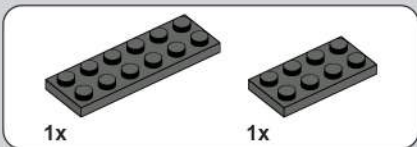
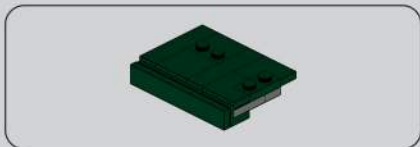

95

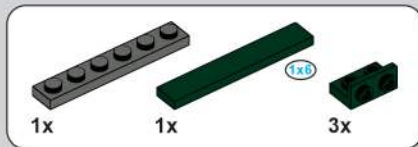

96

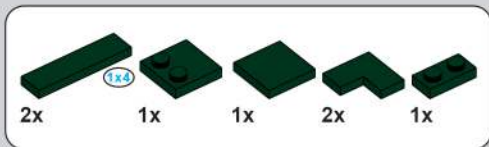
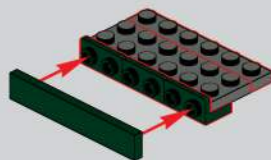
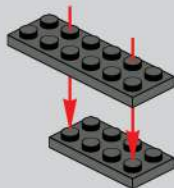

97

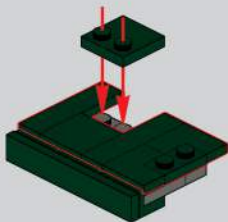

98

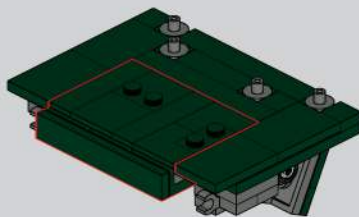



99

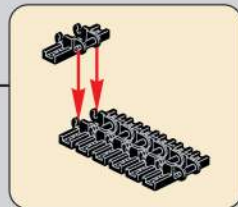
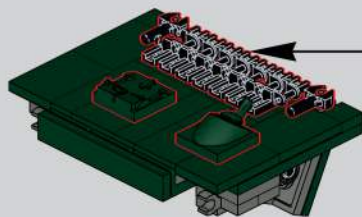

100

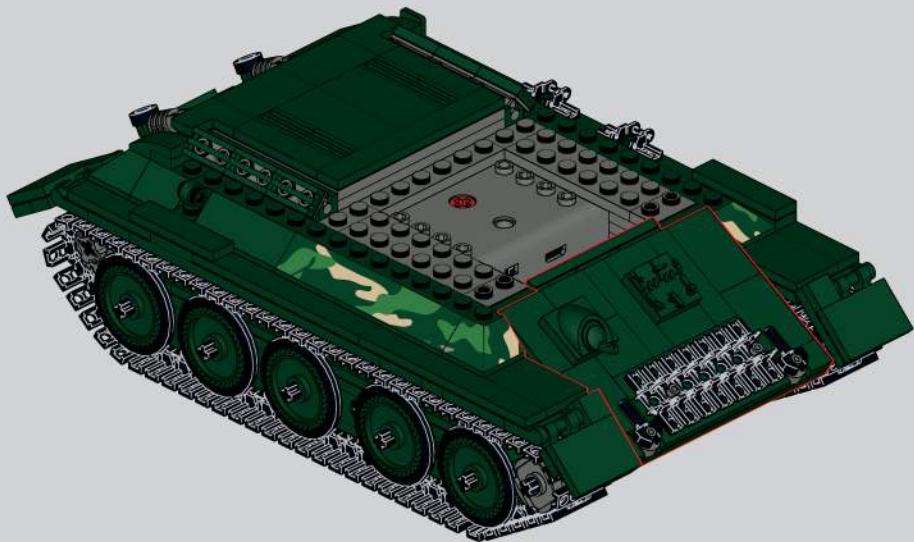

1x 1x 1x 1x 4x

 (光滑栓)

 (Technic Pin without Friction)

101

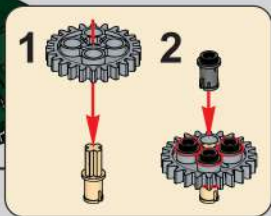
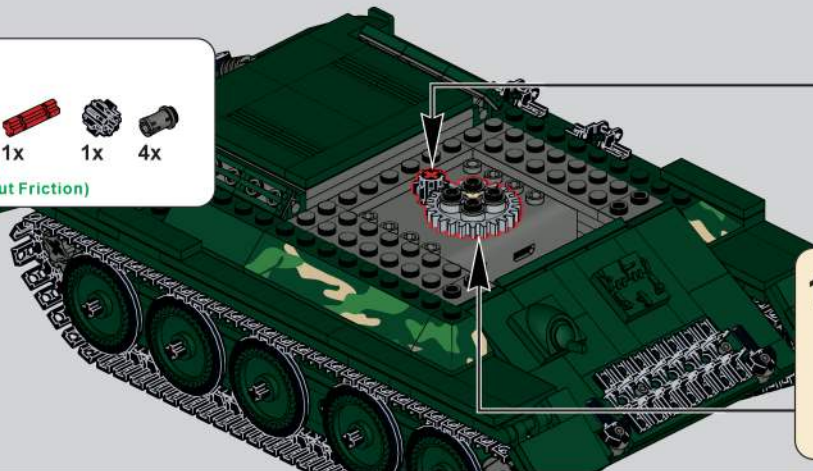

1x 2x 1x 2x 2x

102

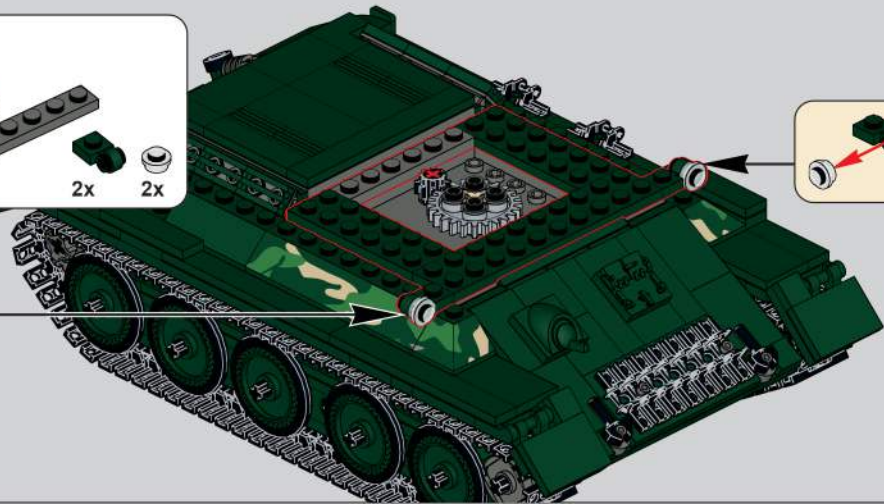

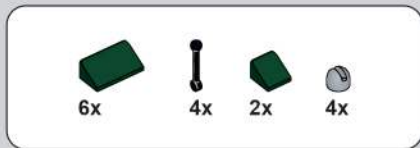

103

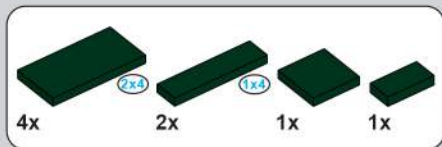
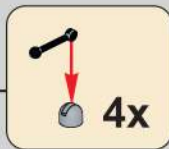
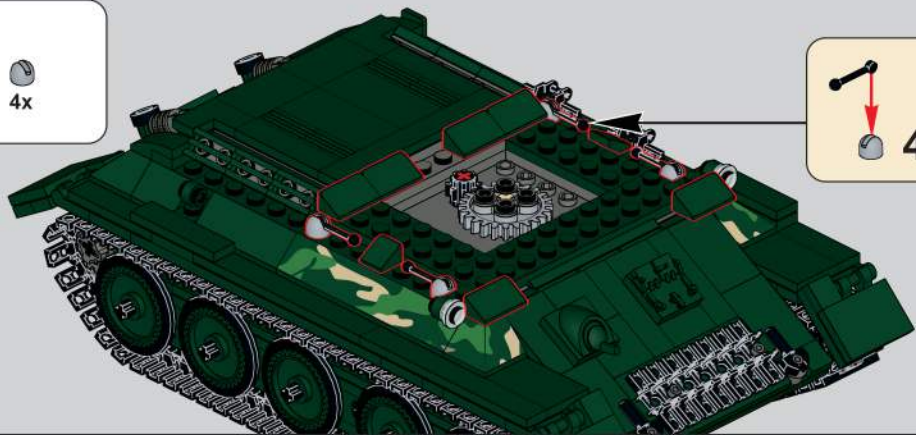

104

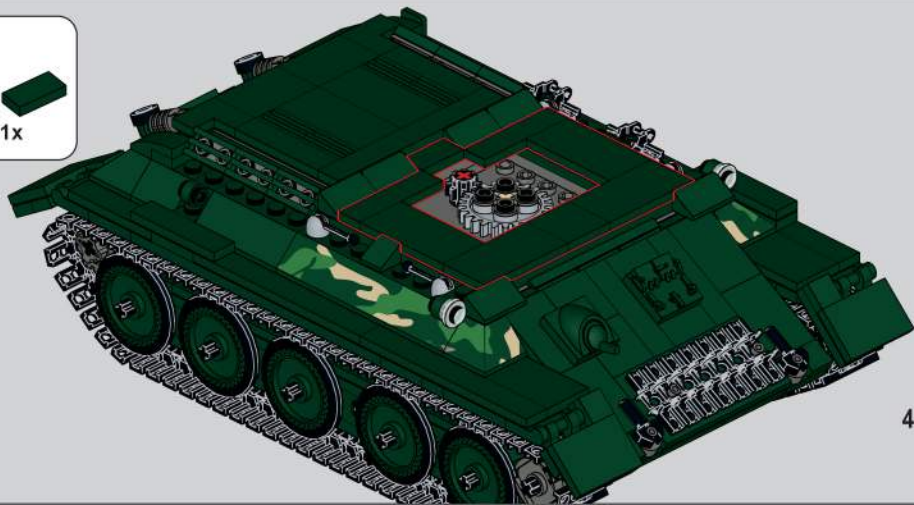

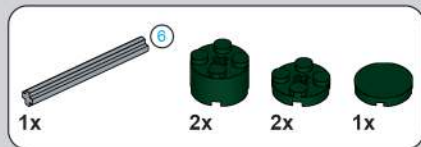

105

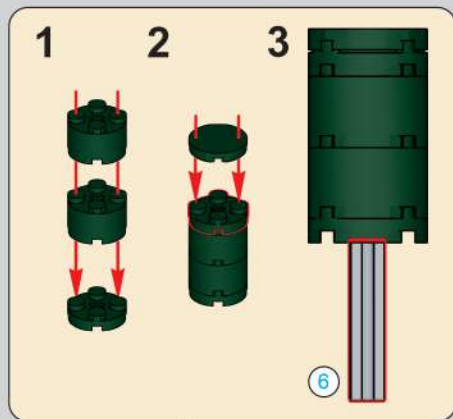
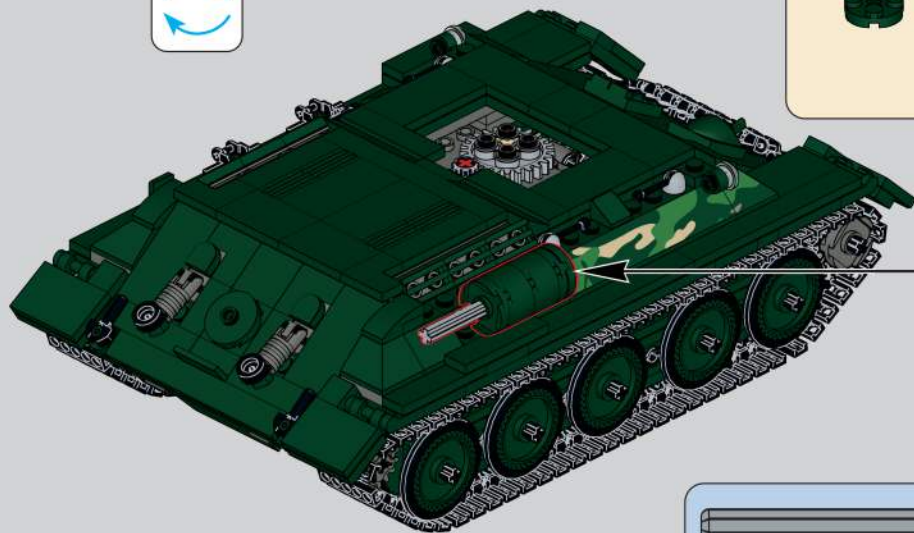



106

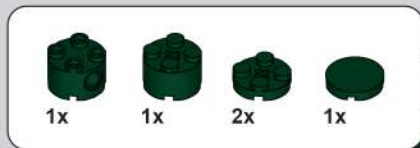
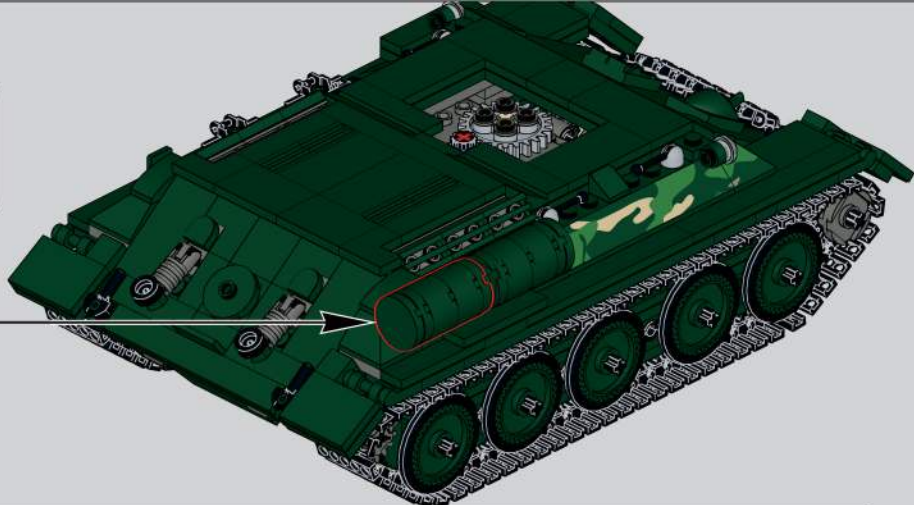
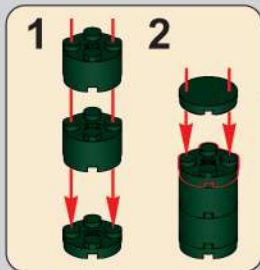

107

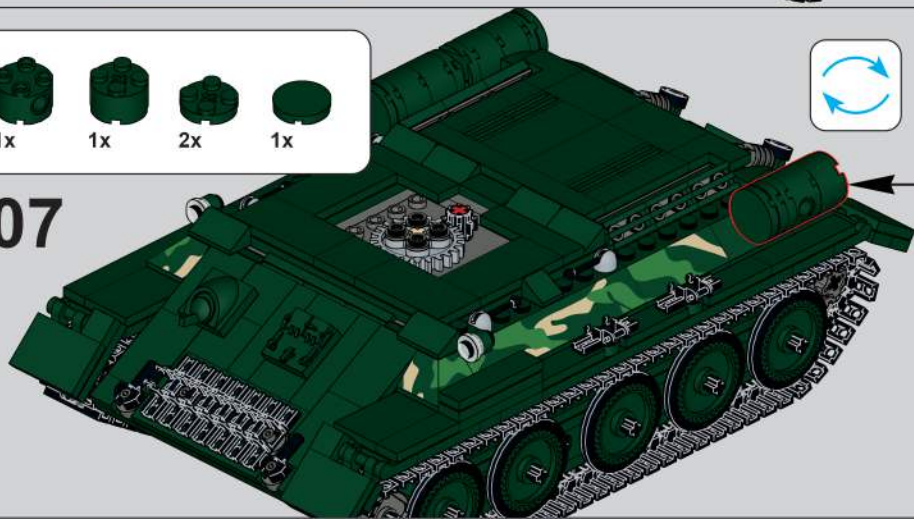
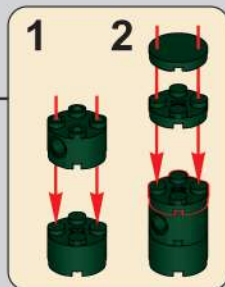

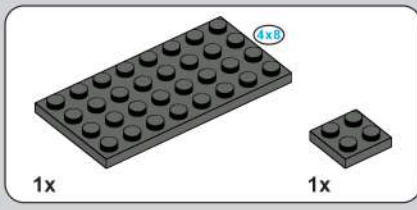

108

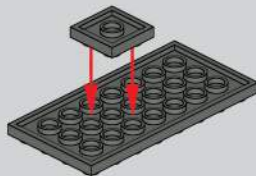

109

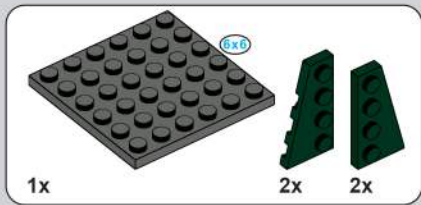
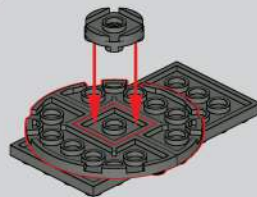

110

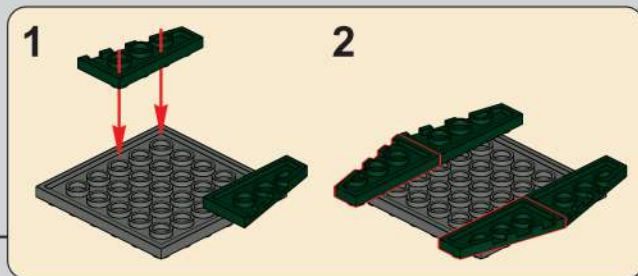
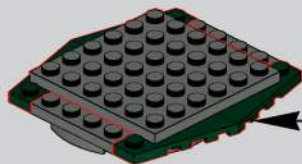

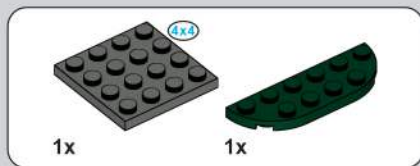

111

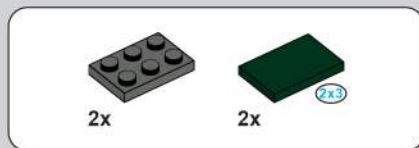
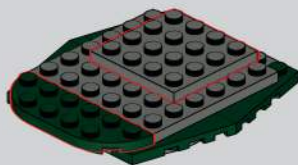

112

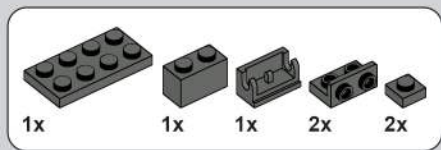
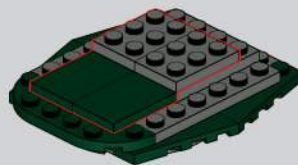

113

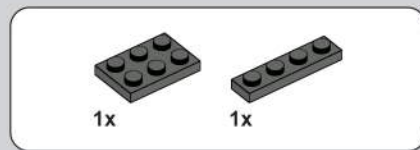
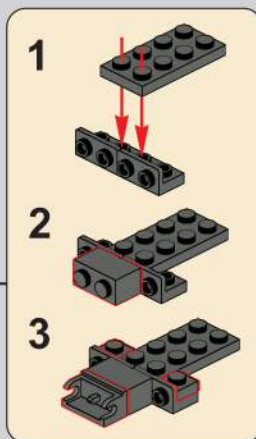
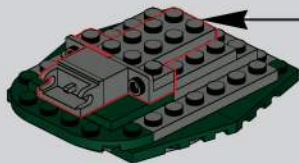

114

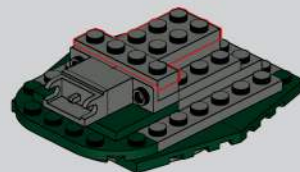



1x



3x



115

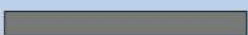
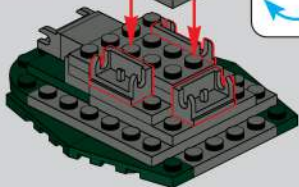

4

1:1



1x



1x

116

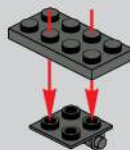

2x



2x

117



1x



3x

118

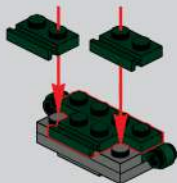

1x



2x



2x

119

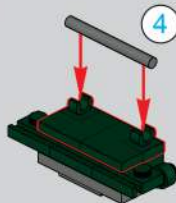

120

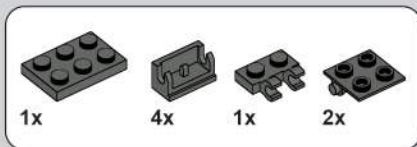
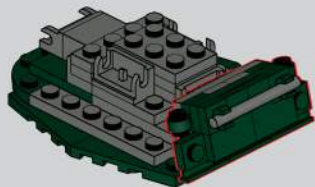

121

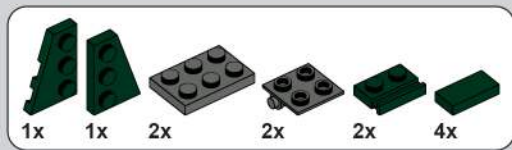
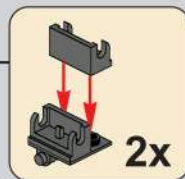
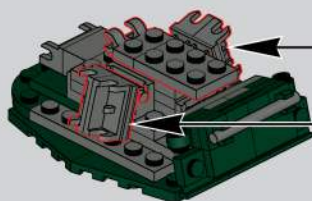

122

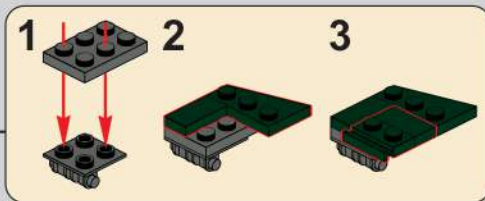
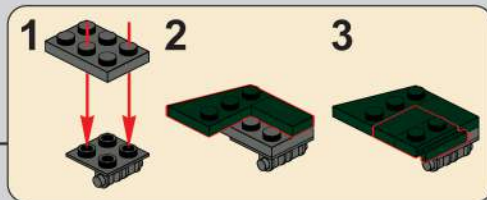
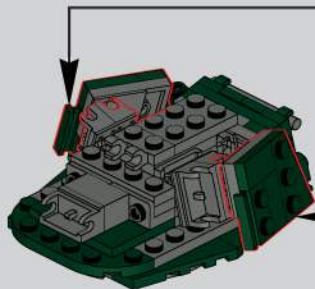

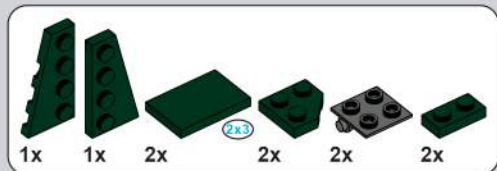

123

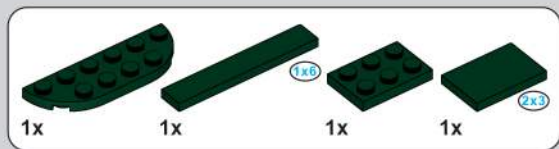
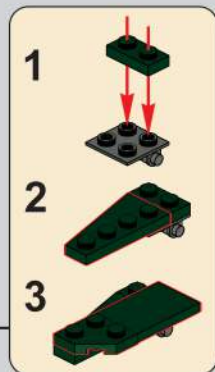
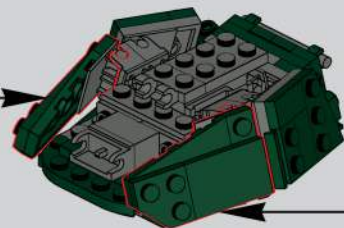
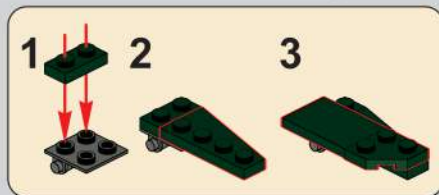

124

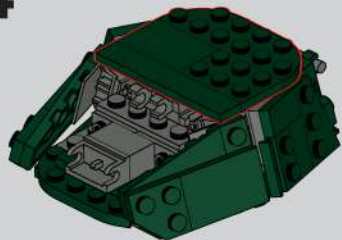

125

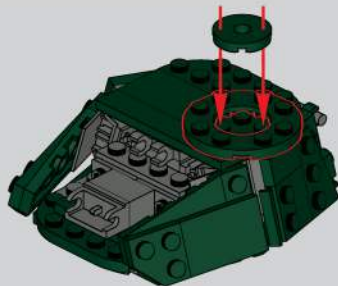

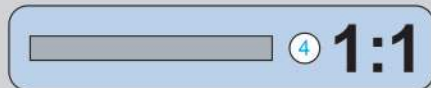
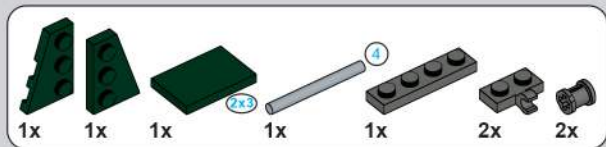

128

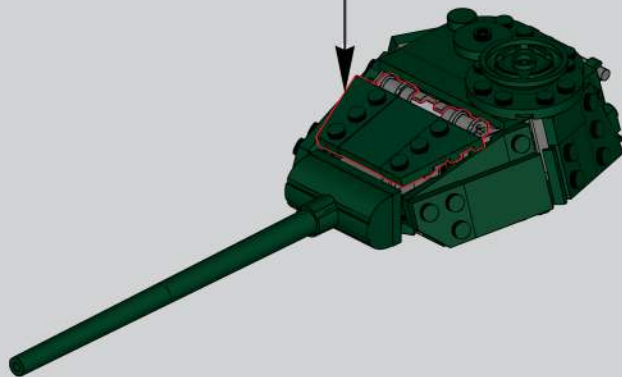
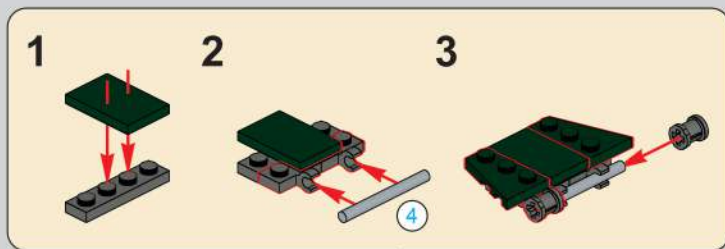

129

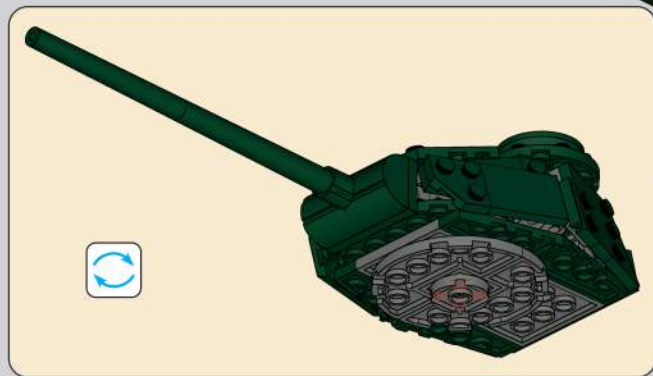
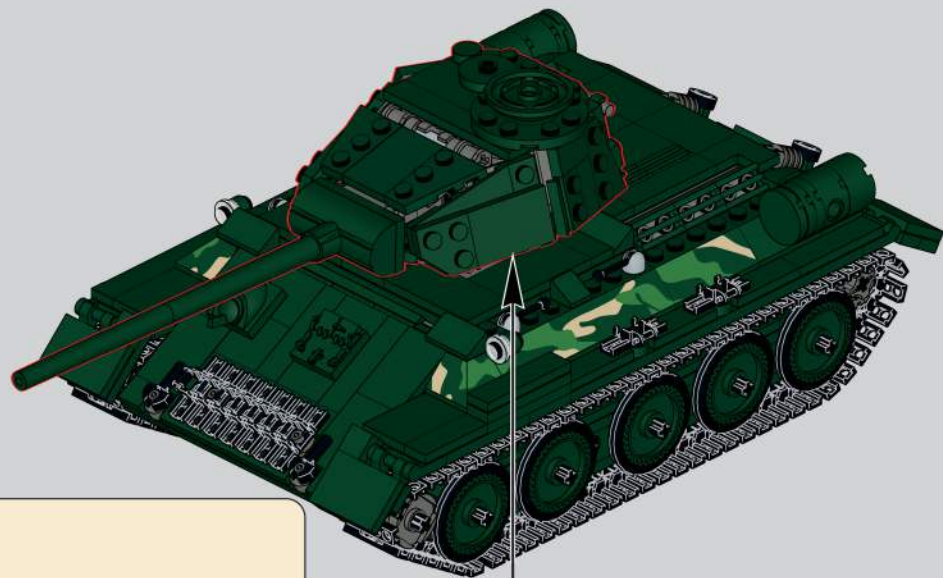

130

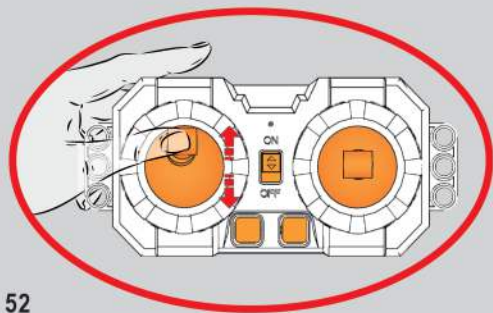
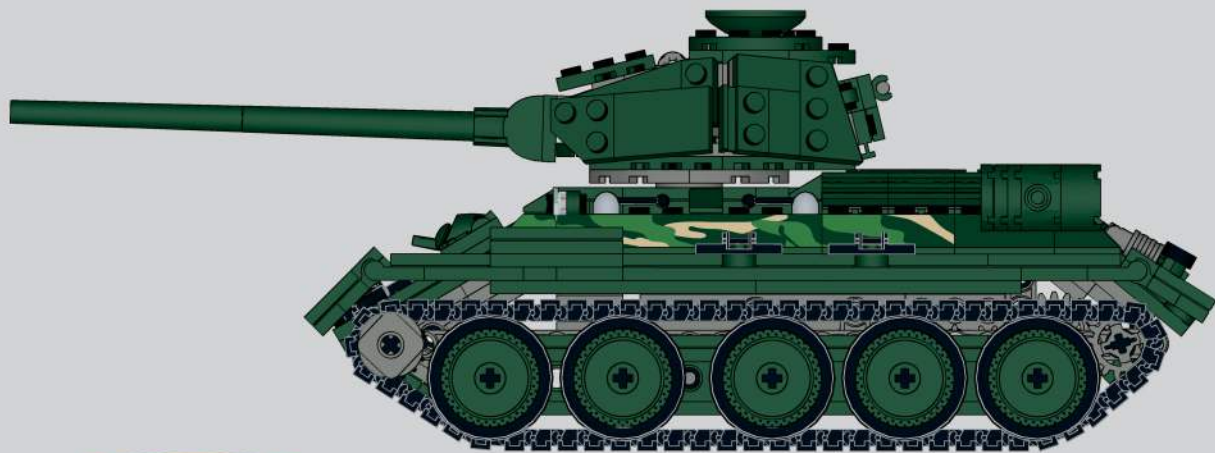

52

131

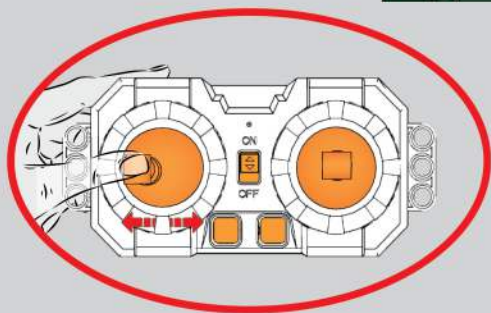
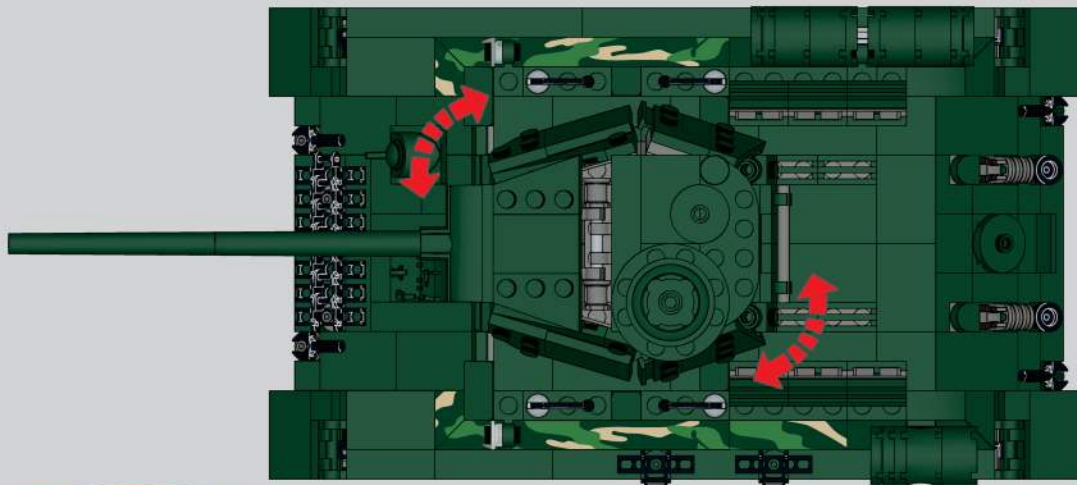

132

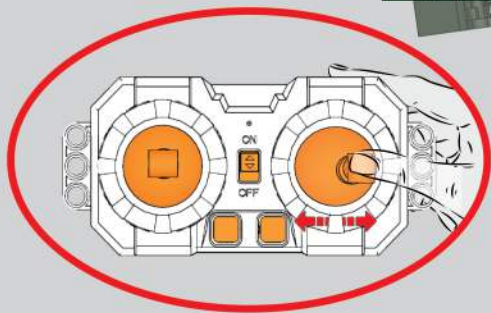
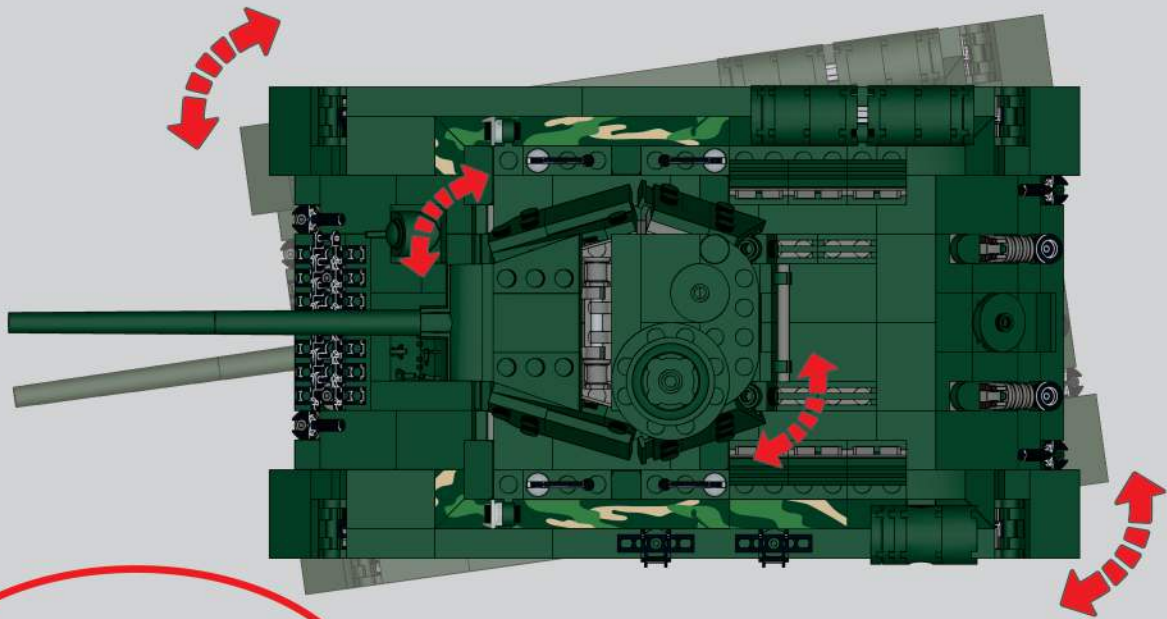

133

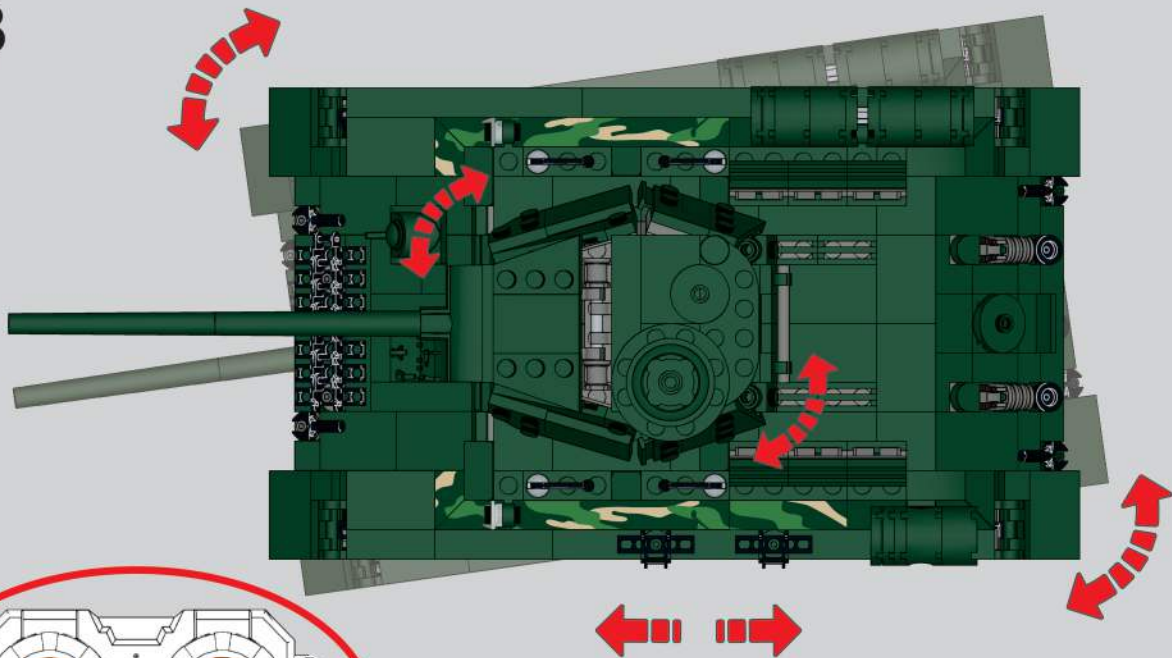
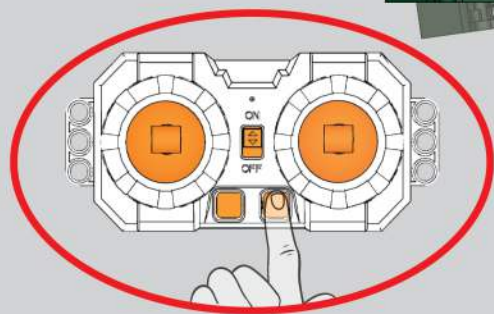

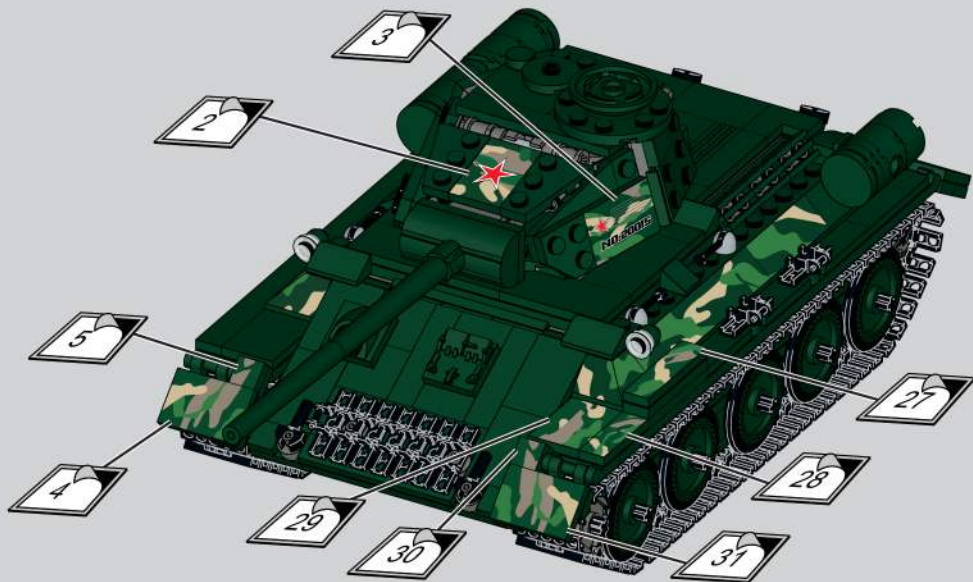

此贴纸为热感压标贴纸，不可重复粘贴

This sticker is a thermal pressure label sticker and cannot be pasted repeatedly

贴纸使用方法：撕起贴纸，对准位置随后均匀刮动，撕掉透明膜即可。

How to use the sticker: Tear off the sticker, align the position and then scrape it evenly, tear off the transparent film.

135

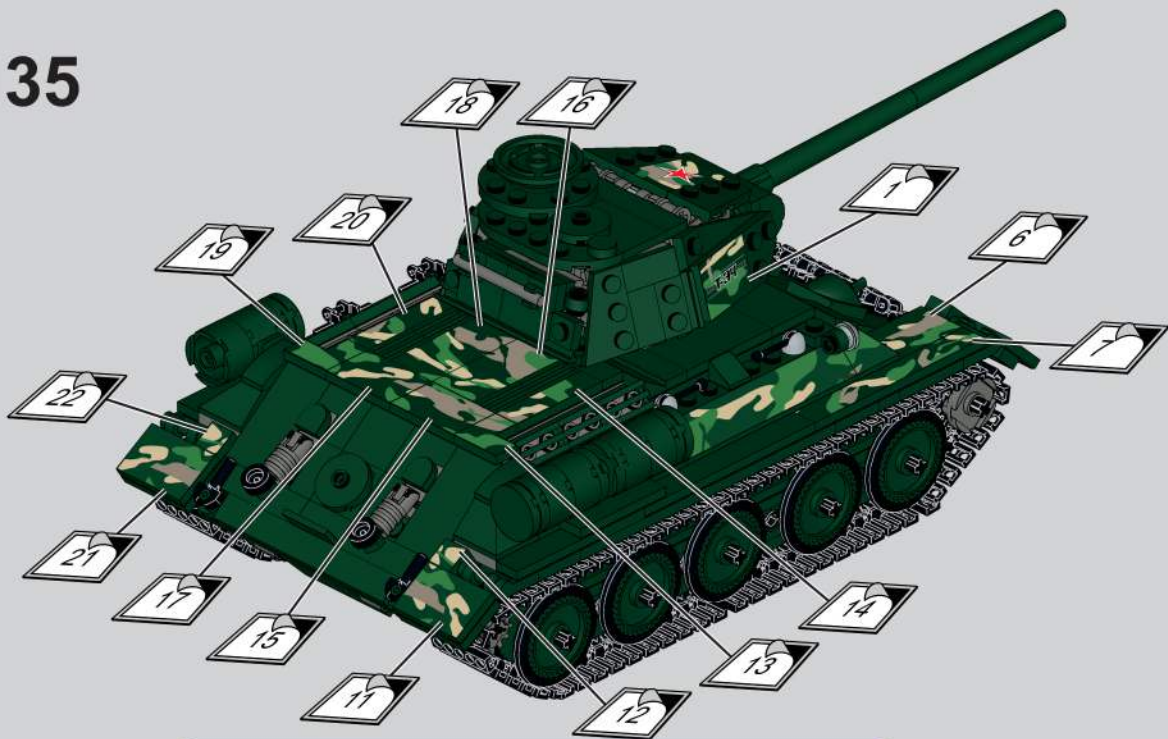

此贴纸为热感压标贴纸，不可重复粘贴

This sticker is a thermal pressure label sticker and cannot be pasted repeatedly

贴纸使用方法：撕起贴纸，对准位置随后均匀刮动，撕掉透明膜即可。

How to use the sticker: Tear off the sticker, align the position and then scrape it evenly, tear off the transparent film.

