



THE BURJ AL ARAB HOTEL OF DUBAI

United Arab Emirates
The world's great architecture

Ages
6+



Creative
Ability

Family
Interaction

Observation
Ability

Thinking
Ability

Practical
Ability



The
**BURJ AL
ARAB HOTEL**
OF DUBAI

NO.5220

1368 PCS

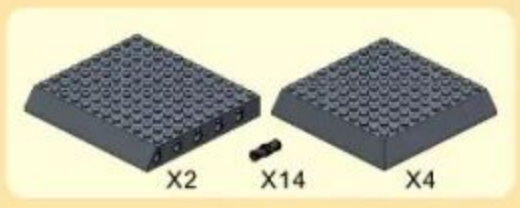

1

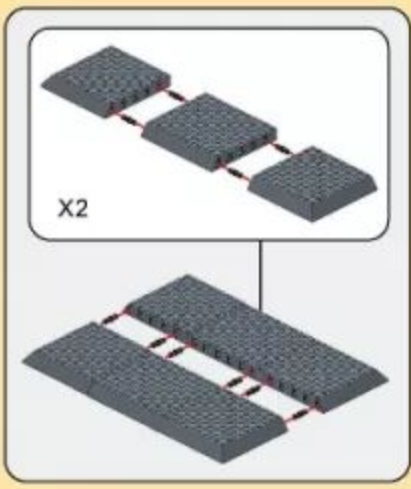
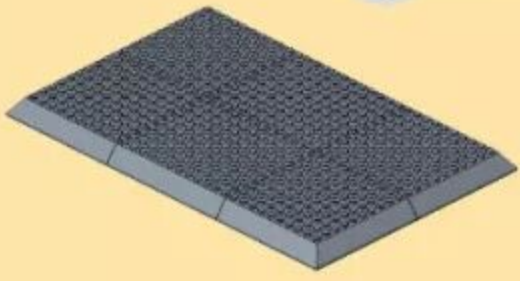

2

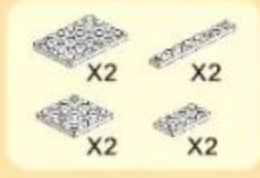
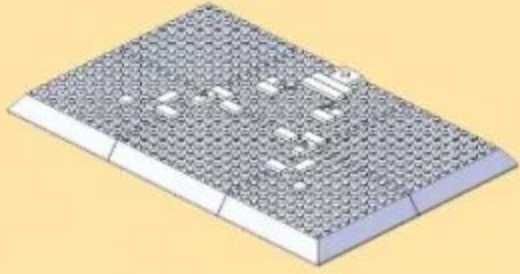

3

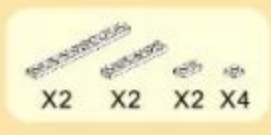
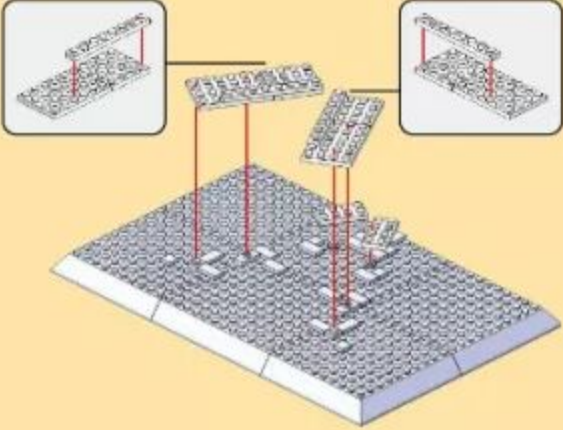

4

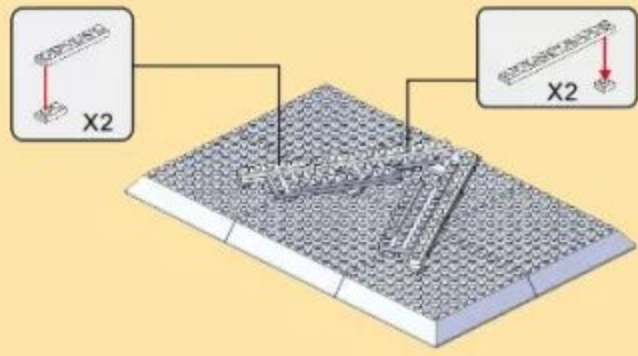

5

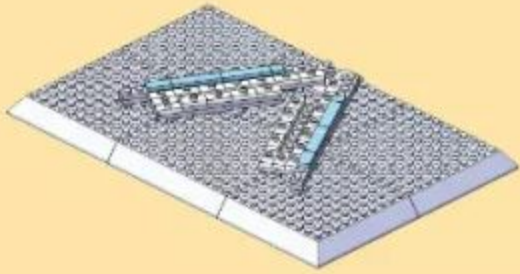

6

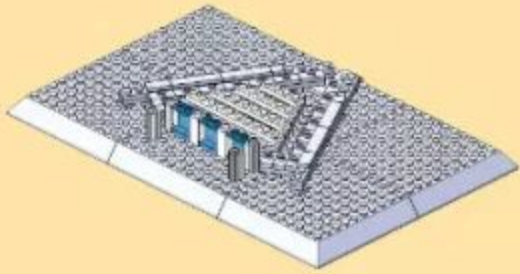

7



X4 X18 X2 X2

8

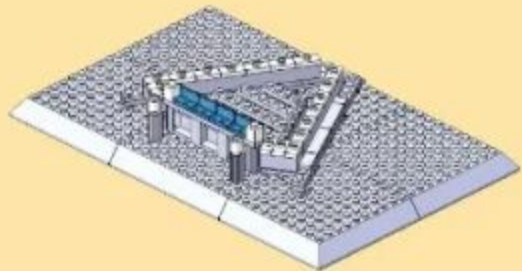

X2 X2

9



X18 X2 X2
X2 X2

10

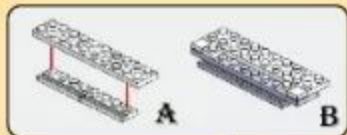

X2 X2 X2
X2 X2 X4
X1 X1

11

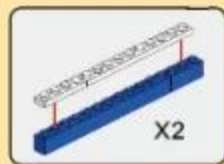

X2

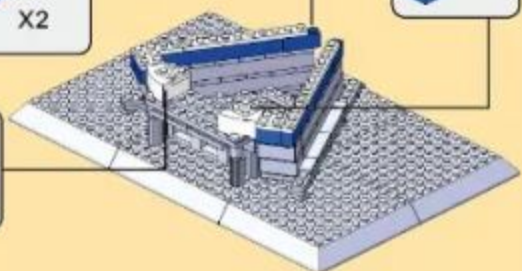

X2 X2 X2
X3 X1 X1

12

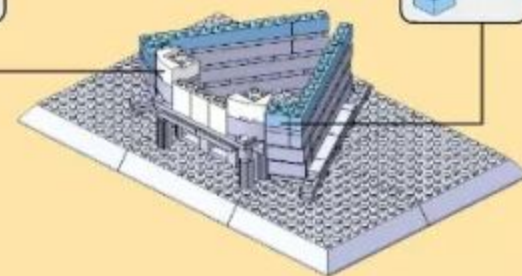

X1 X1 X18

13



X2 X1
X2 X1 X1

14

X2



X2 X2 X6
X2 X6 X10

15

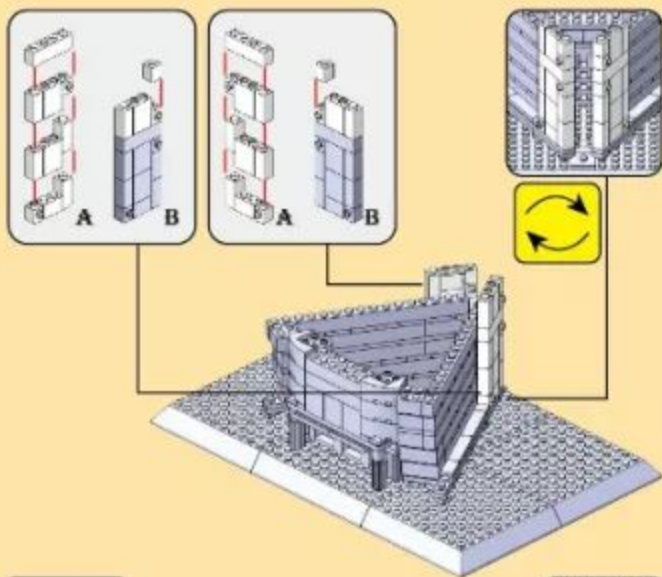

X1 X1 X1
X3 X1 X1 X18

18

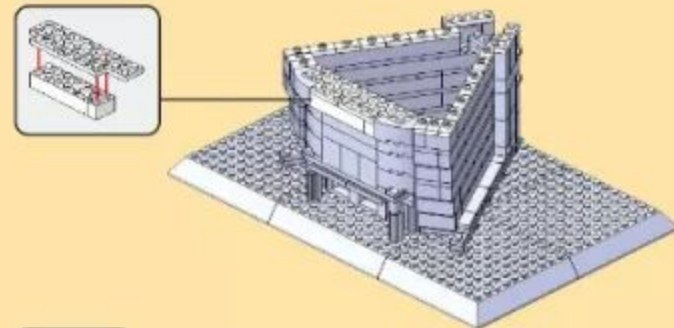

X2 X1 X2 X3
X2 X2 X7 X1 X2

16

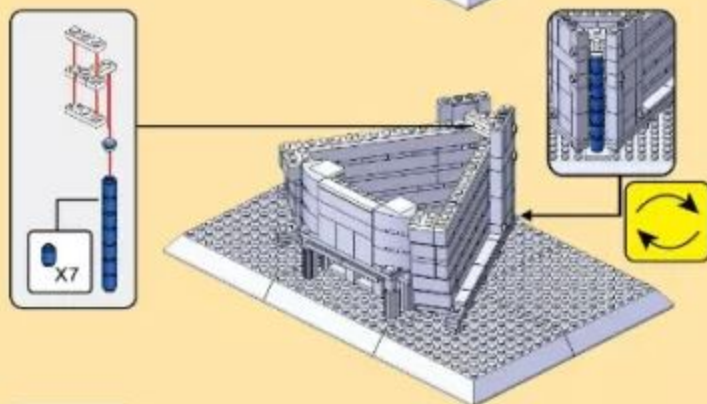

X2 X2 X1 X2
X2 X1 X1 X4

19

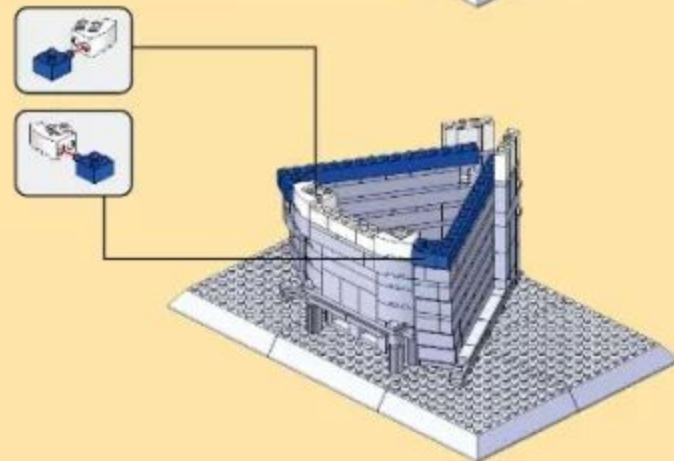

X2 X2 X4
X2 X1 X1

17

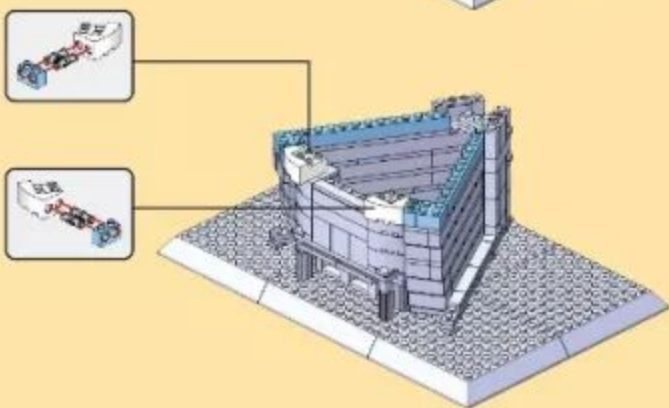

X2 X5 X1
X2 X2

20

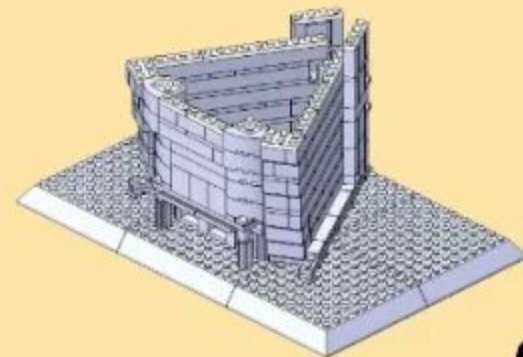



21

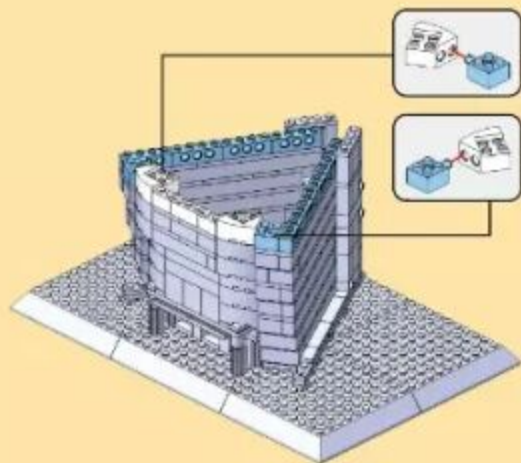

22

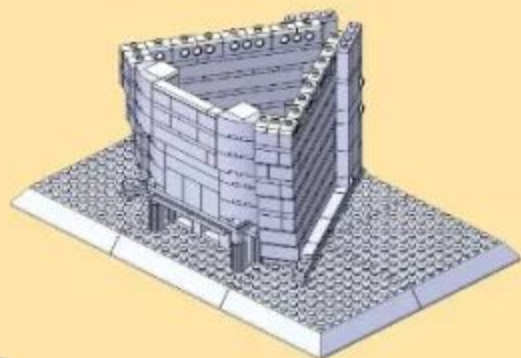

23

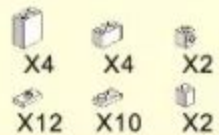
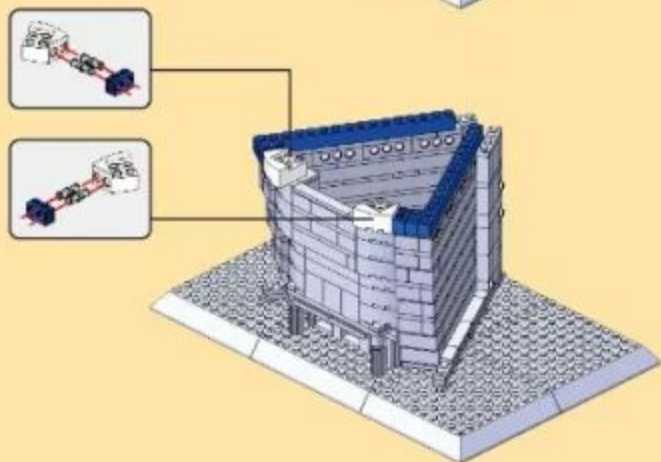

24

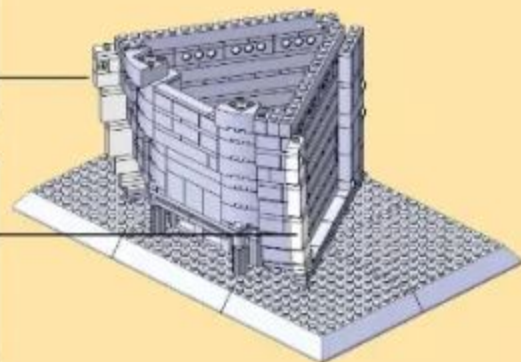
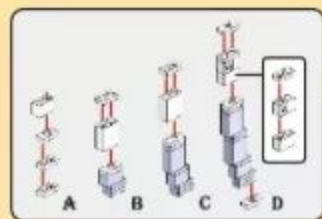
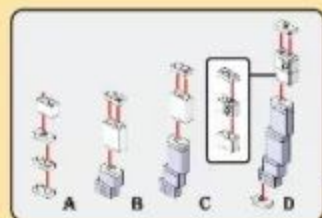

25

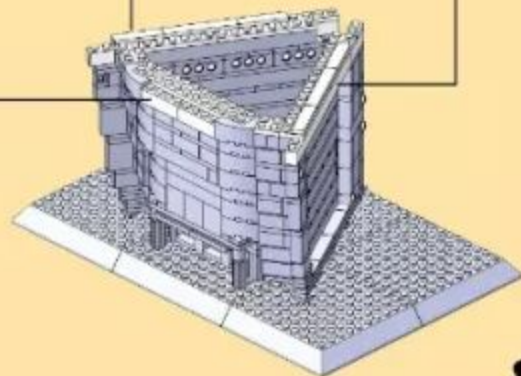
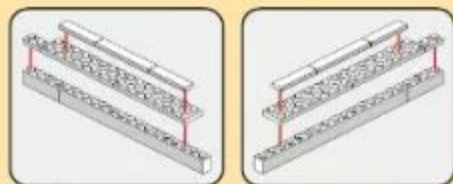

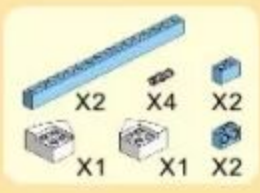

26

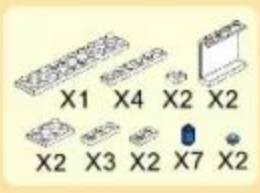
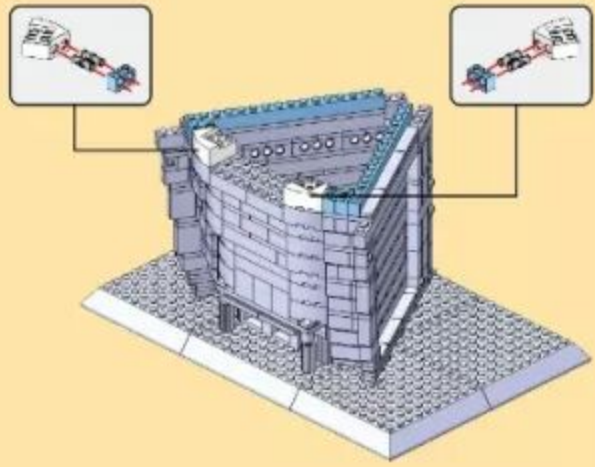

29

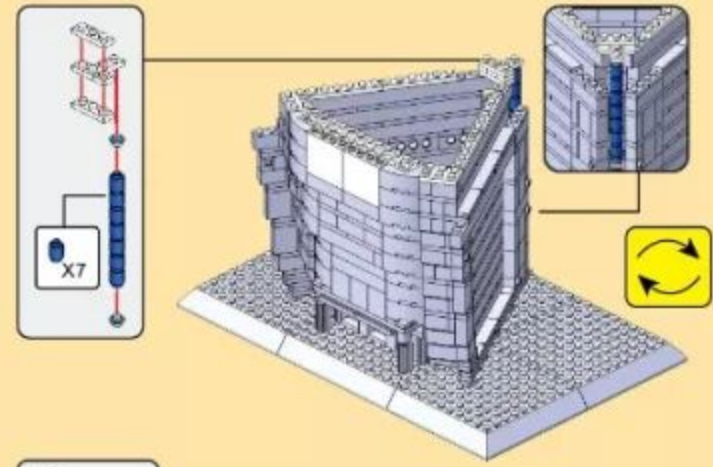

27

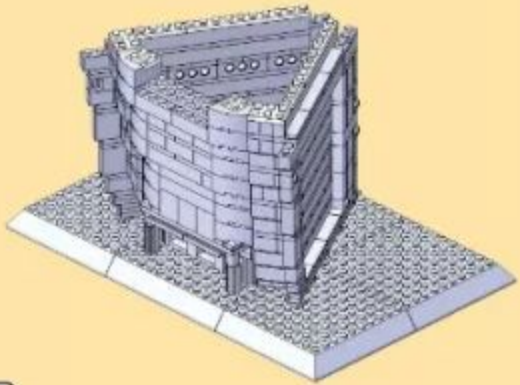

30

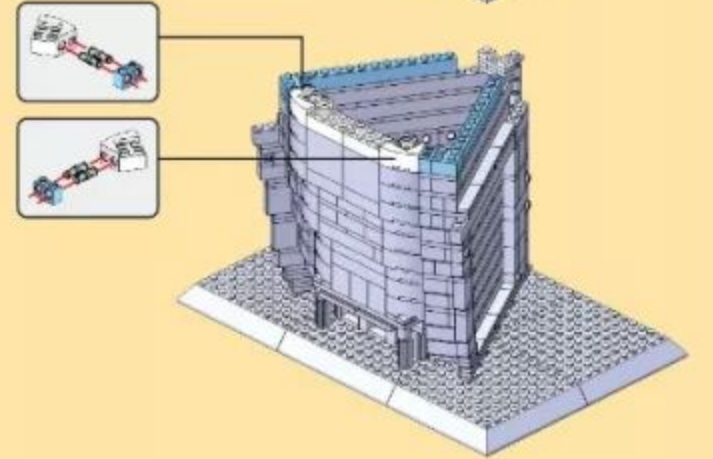

28

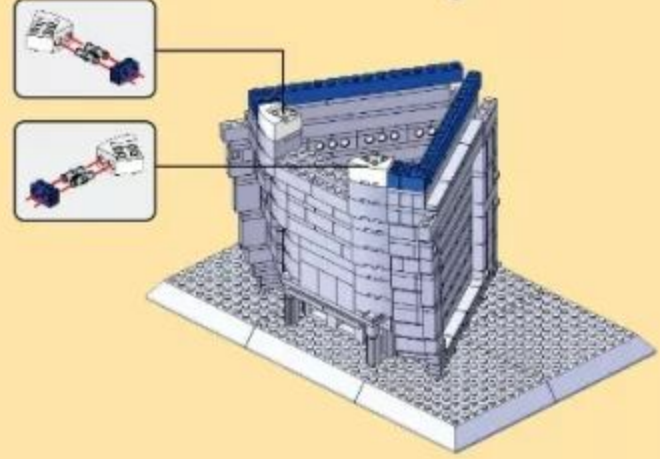

31

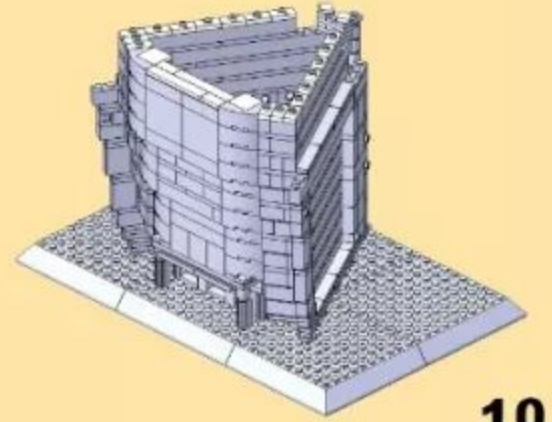



32

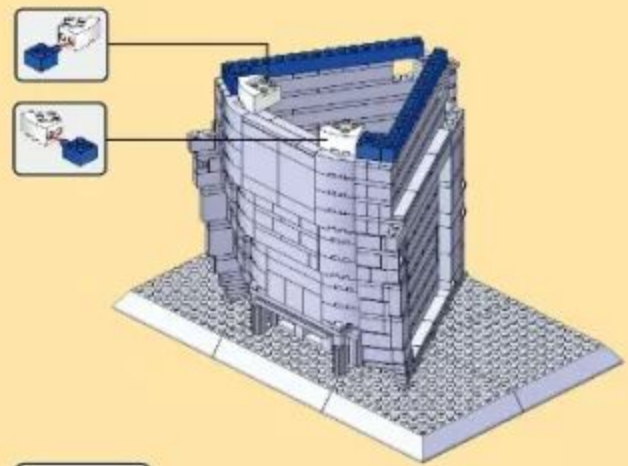

35

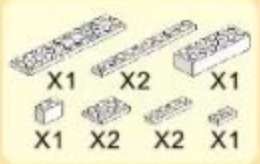
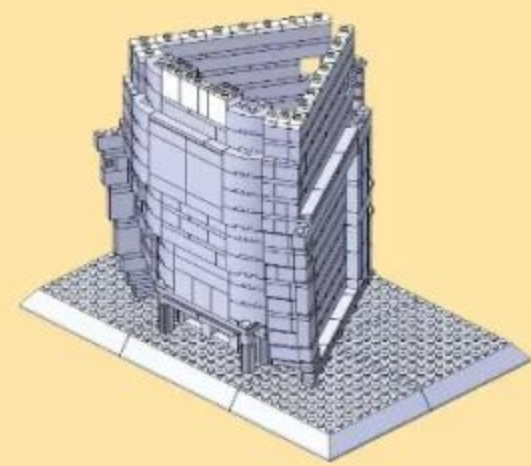

33

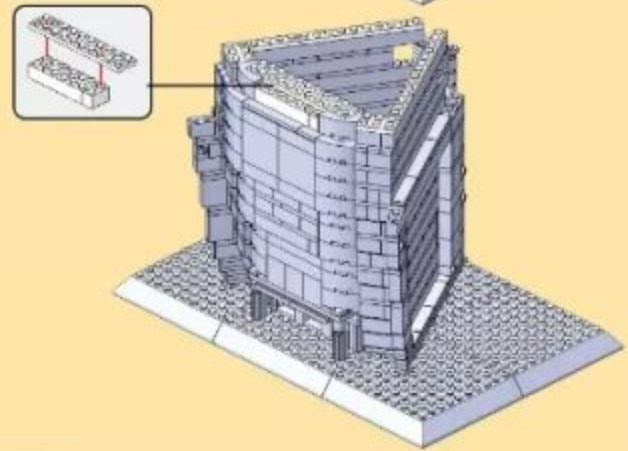

36

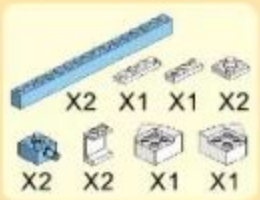
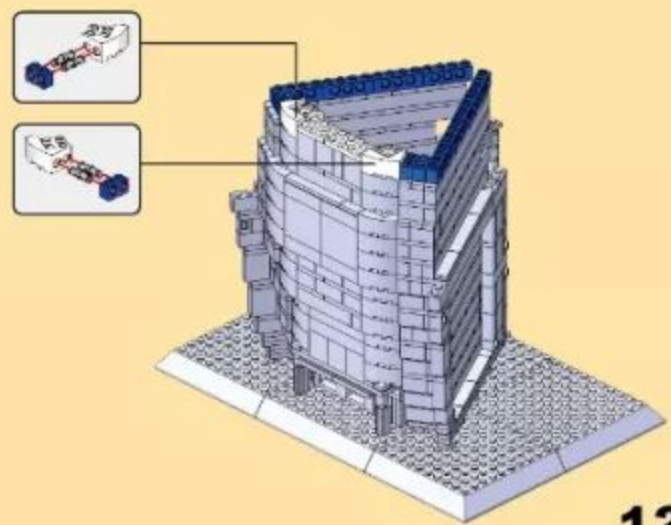

34

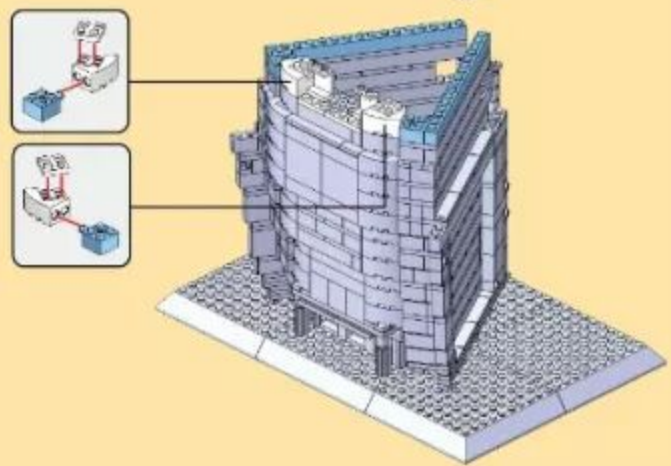

- X2
- X1
- X20
- X1
- X1

37

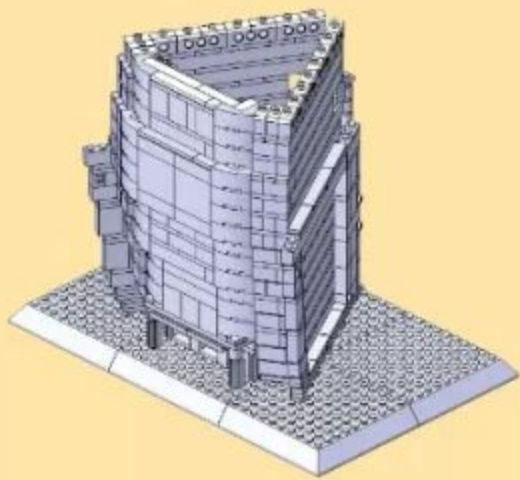

- X6
- X2
- X2
- X4
- X4
- X2

39

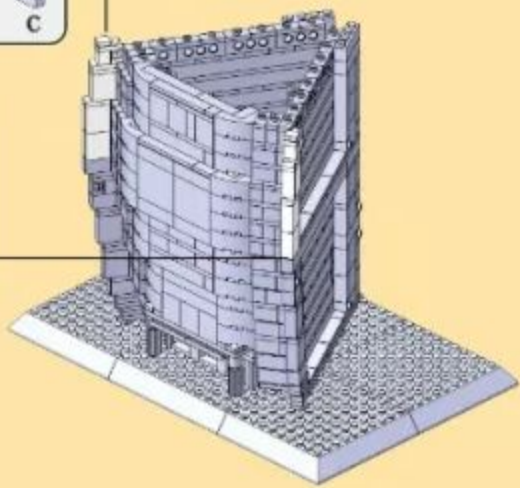
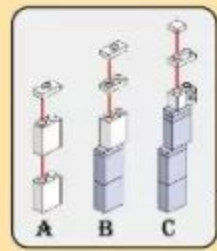
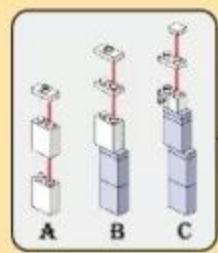

- X4
- X2
- X2
- X4
- X4
- X6

38

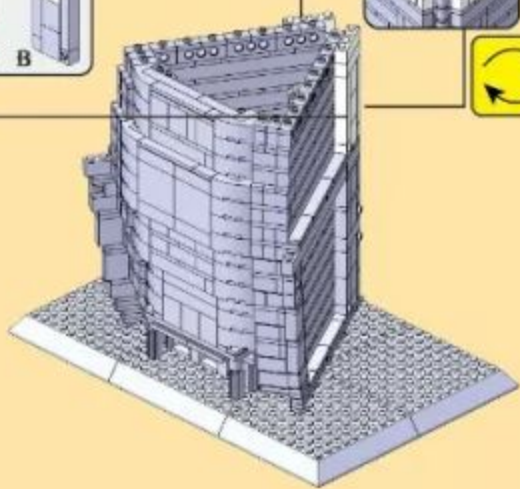
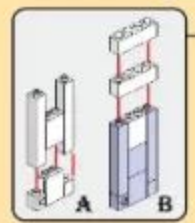
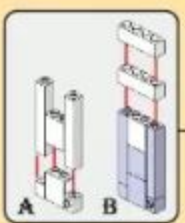

- X2
- X2
- X2
- X4
- X2
- X1
- X1
- X2

40

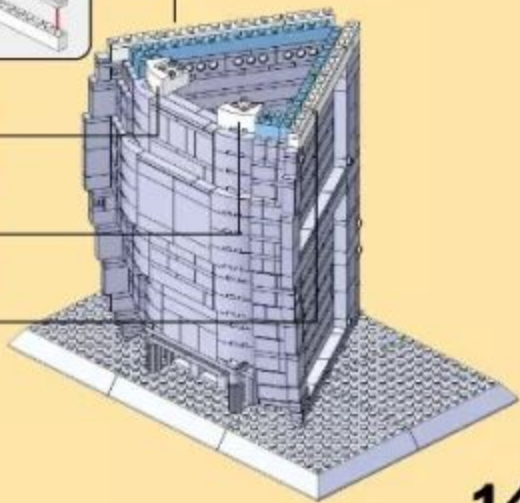



41

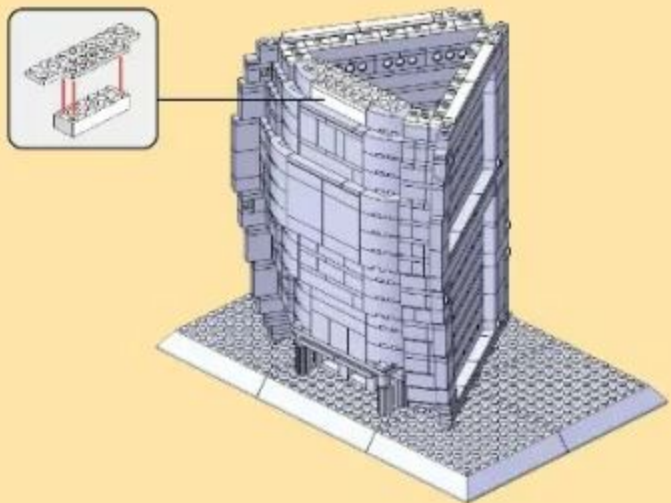

43

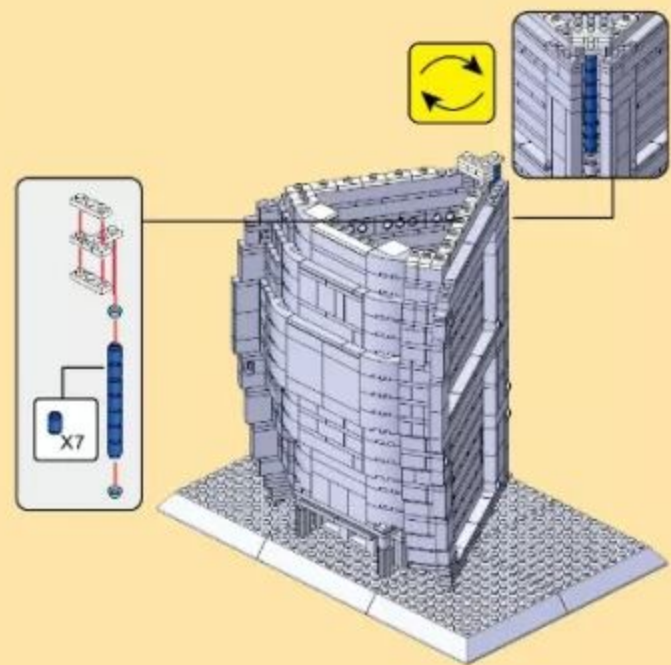

42

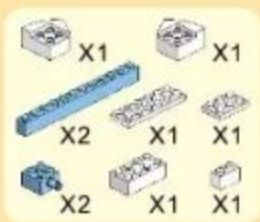
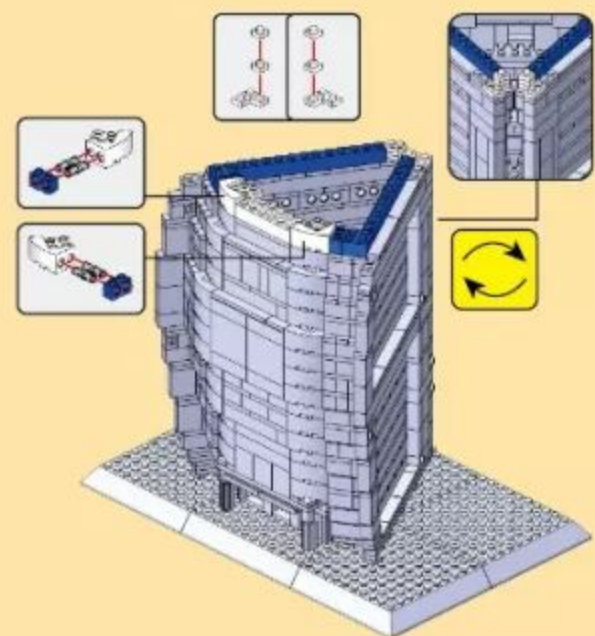

44

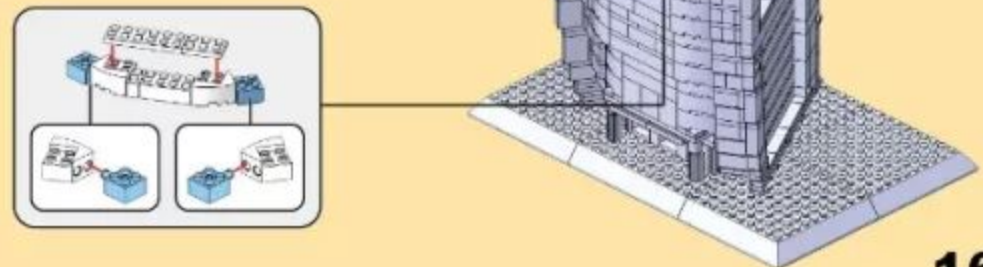

X1 X16 X1

45

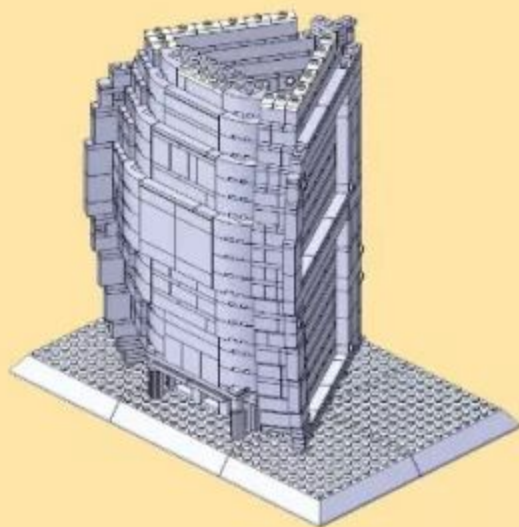

X3 X18 X2

47

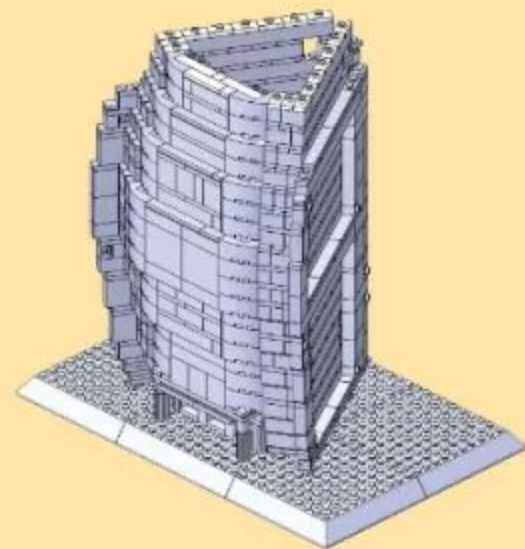

X2 X2 X2 X4
X2 X2 X2 X4
X1 X1 X1 X1

46



X2 X2 X2 X2
X1 X1

48





49

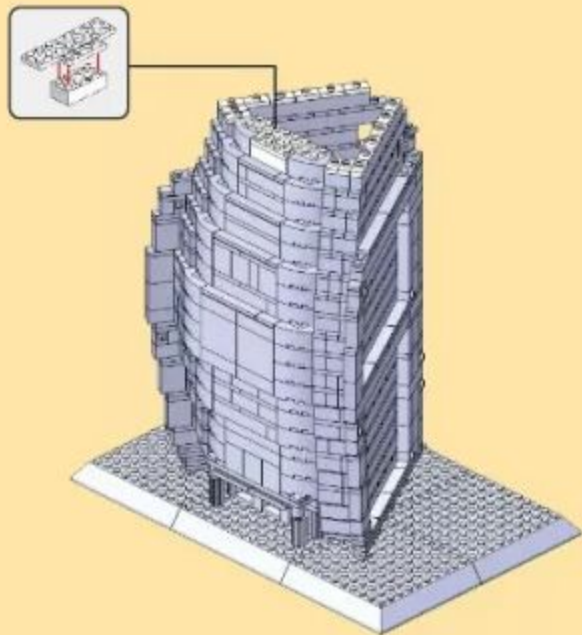

51

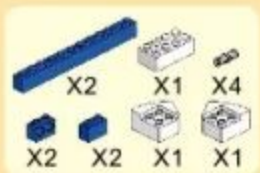
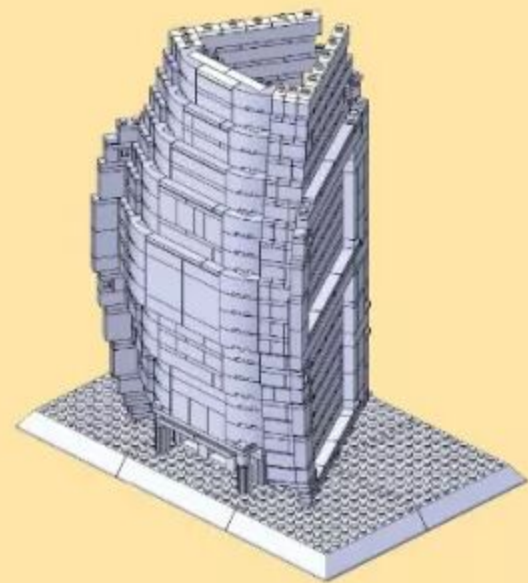

50

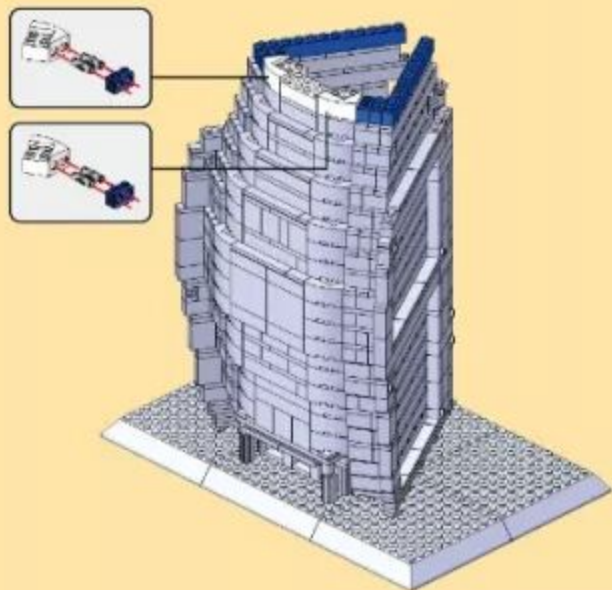

52

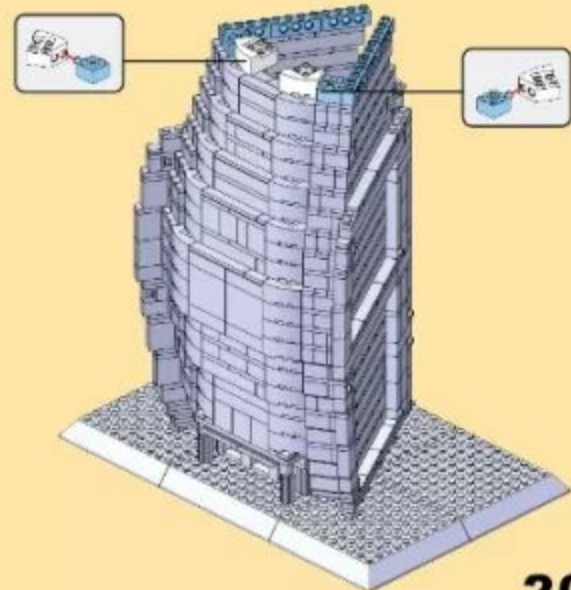

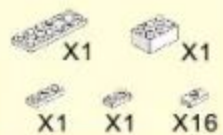

53

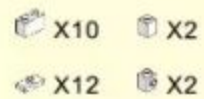
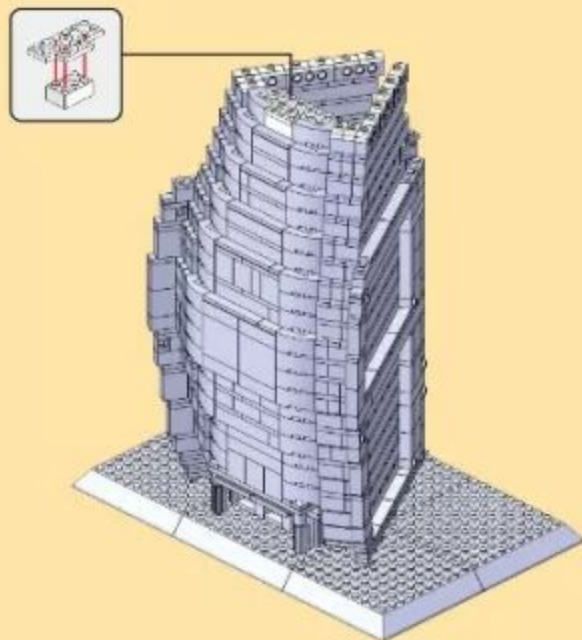

55

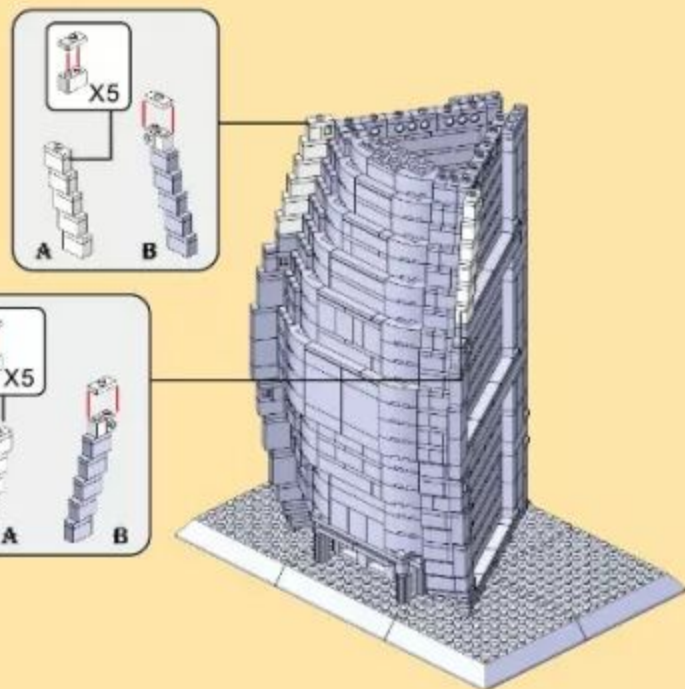

54

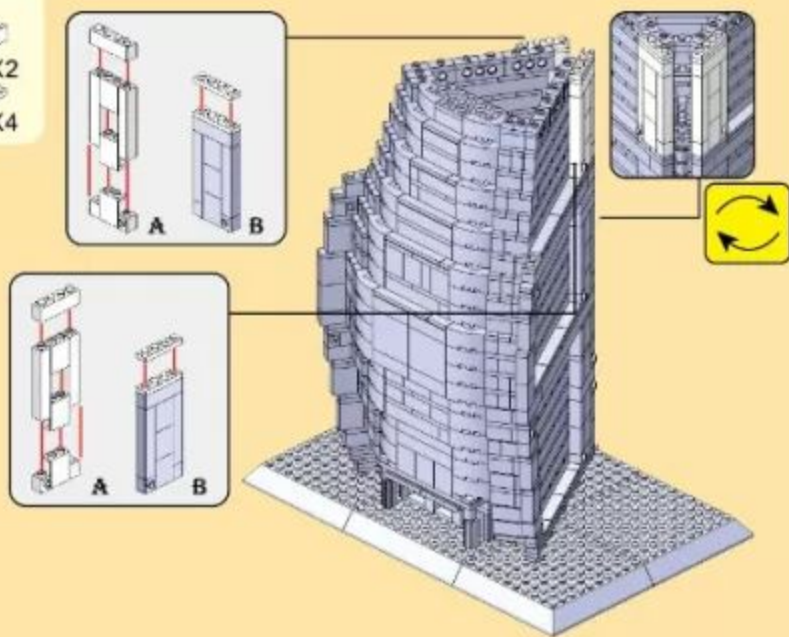

56

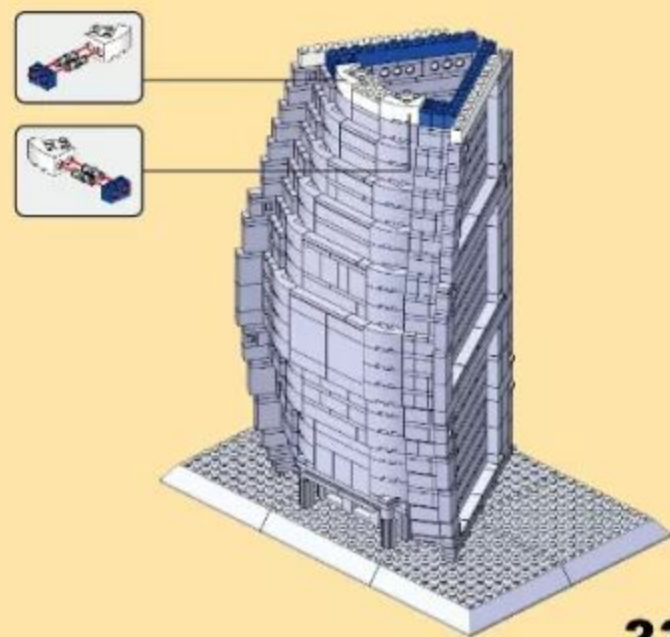

- X2 X2 X4 X7
- X3 X1 X3 X6 X2

57

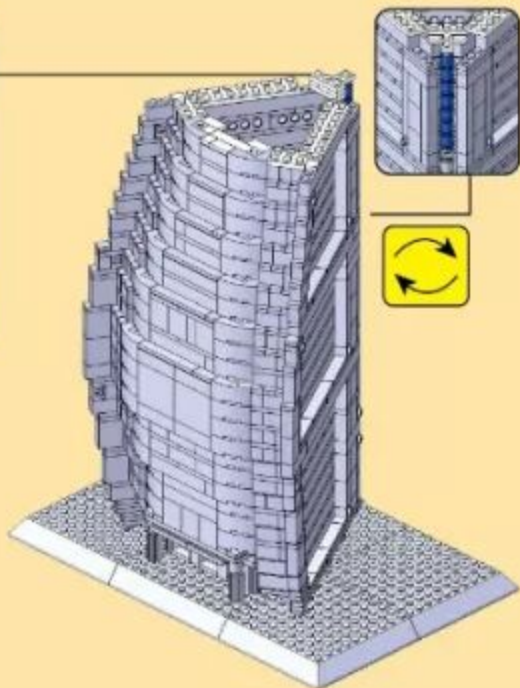
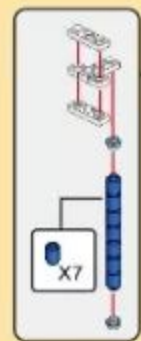

- X2 X2
- X6 X2

59



- X2 X2 X1
- X2 X2 X2

58

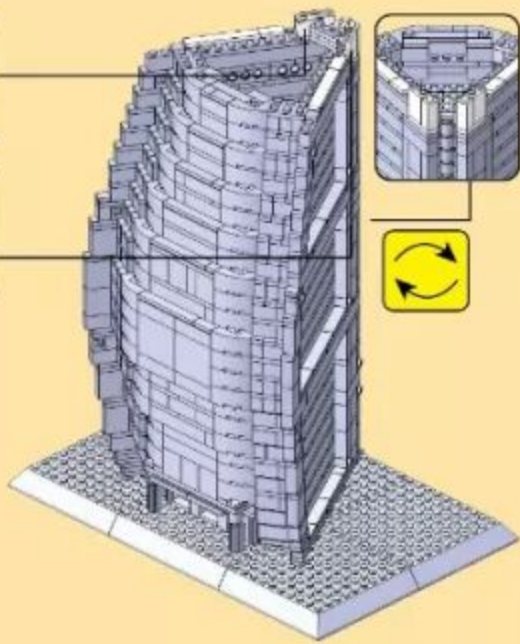

- X2 X2 X2
- X6 X2 X2

60

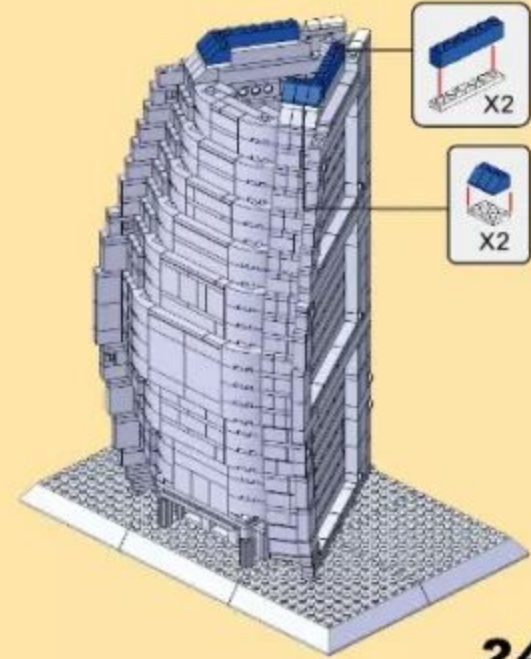
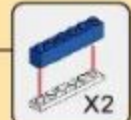

- X1 X1 X1
- X2 X2 X6 X6
- (4pcs) X2 X1 X2

61

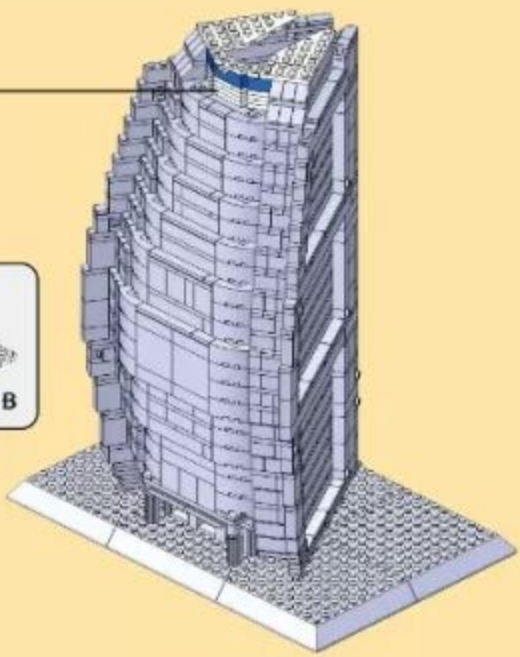
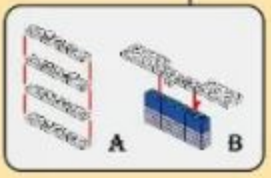

- X2 X2 X2
- X1 X1 X2 X1

62

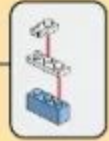
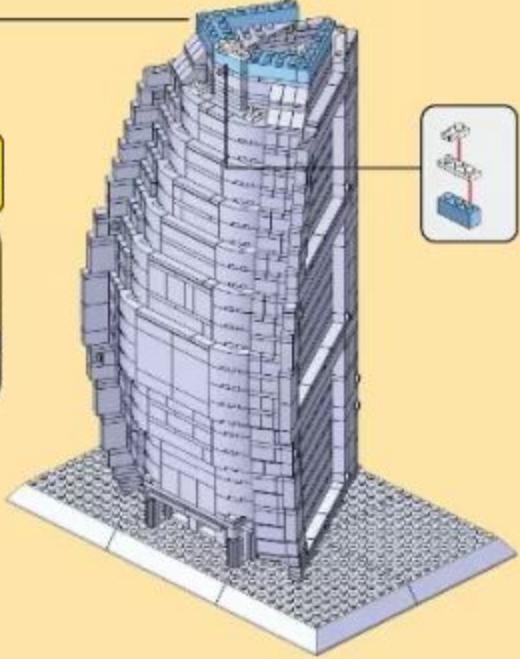

- X3 X2 X1 X1 X8 X4 X1
- X2 X2 X2 X2 X1 X3
- X4 X3 X1 X2 X4 X4

63

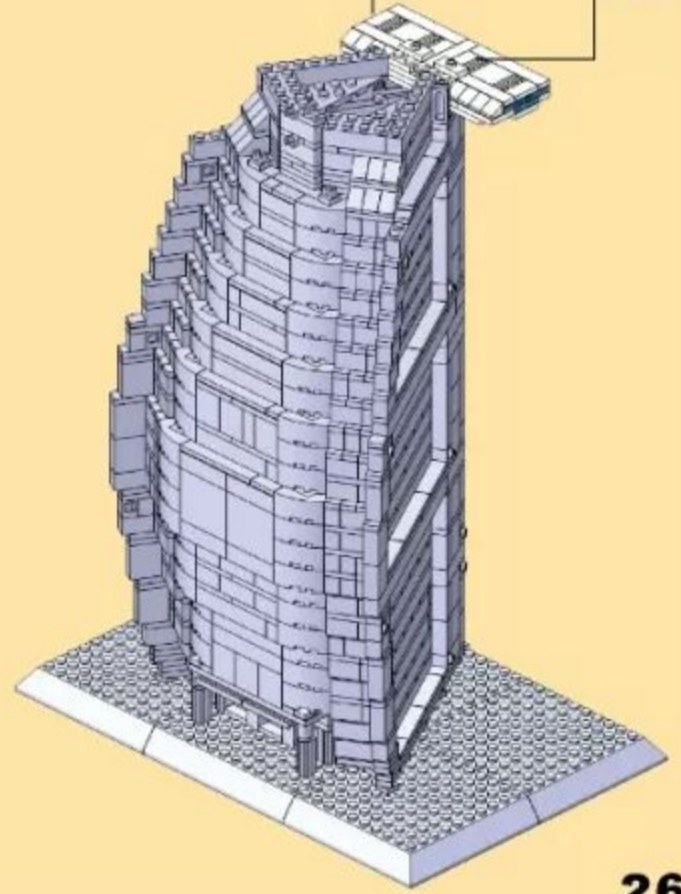
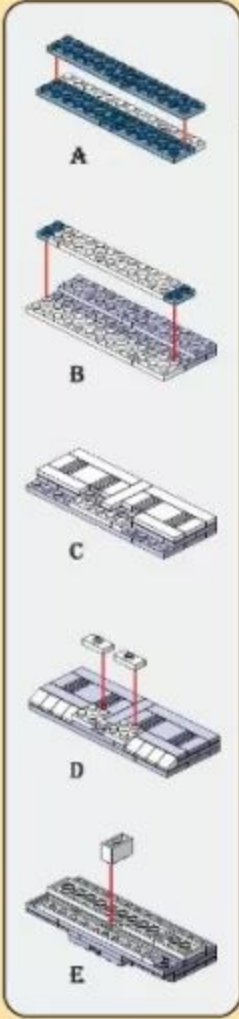

- X2 X4 X2
- X2 X4 X2
- X1 X2 X3

64

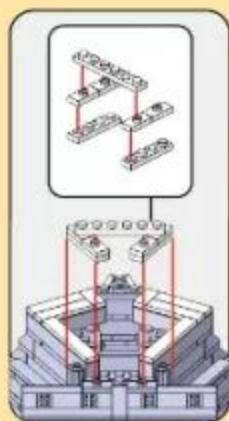

X2

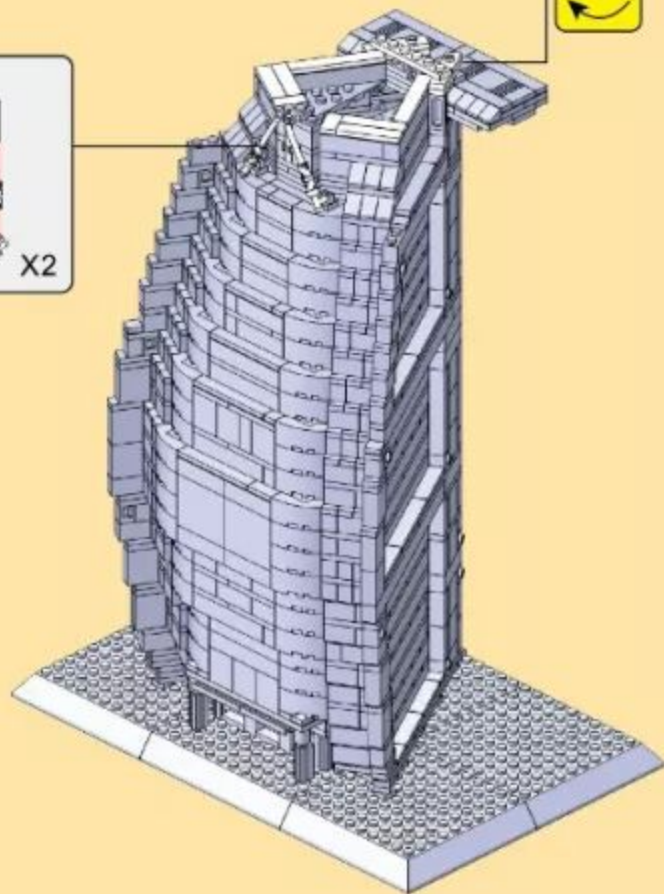

- X1 X2 X2
- X6 X2 X2
- X1 X3 X1 X15

65

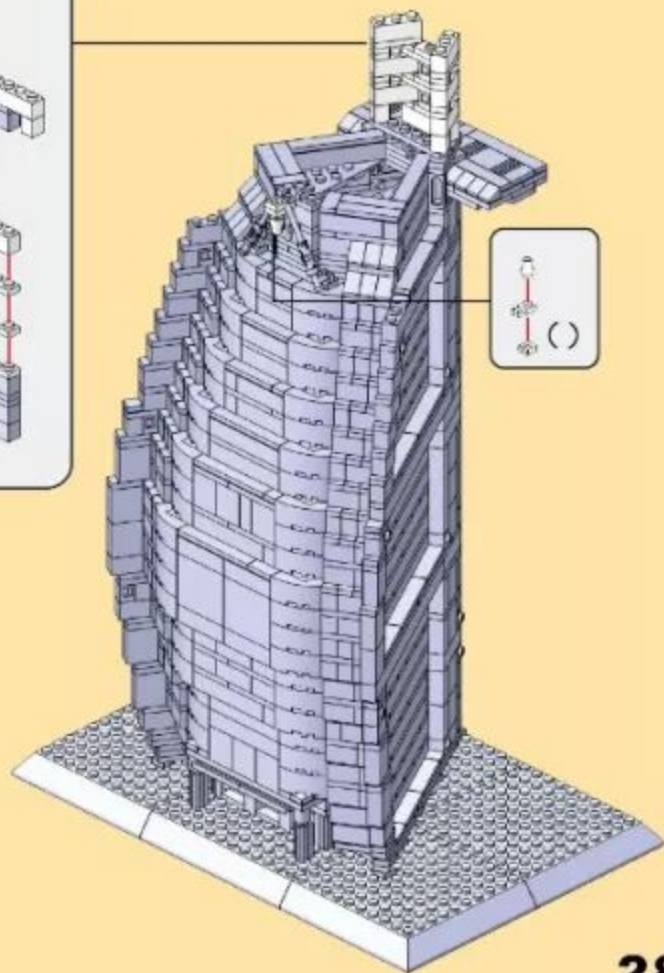
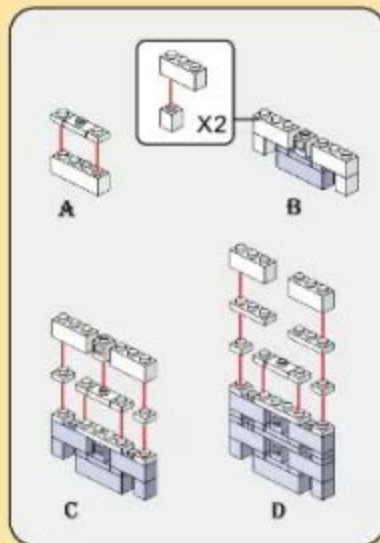

X1

- X30 X30 X2 X2
- X22 X2 X2

66

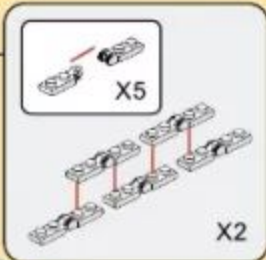
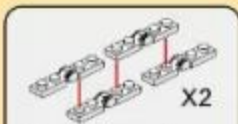
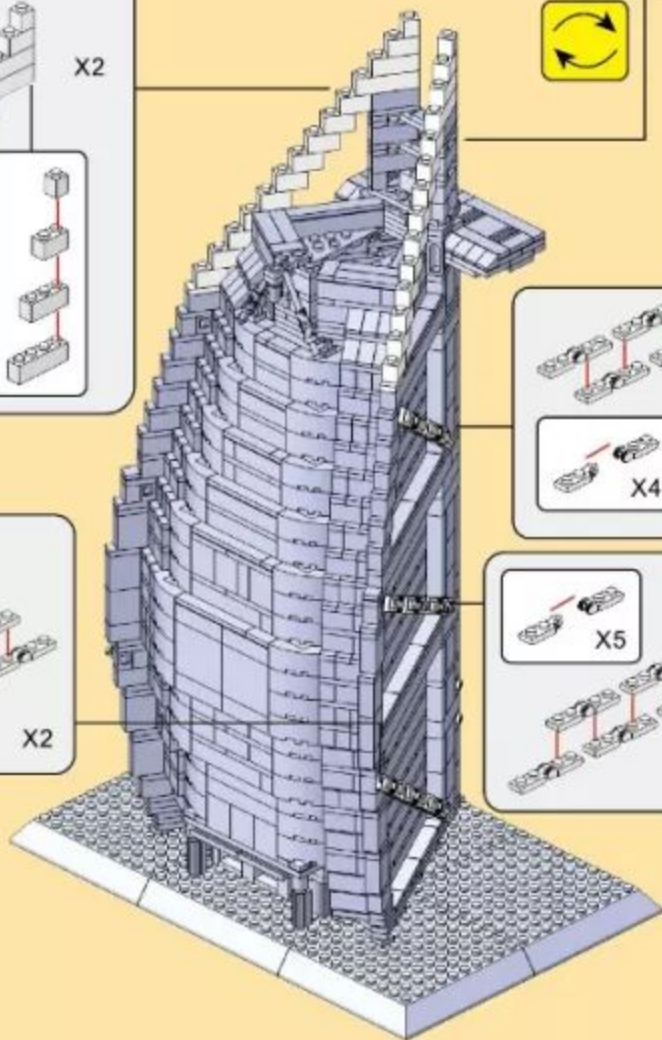
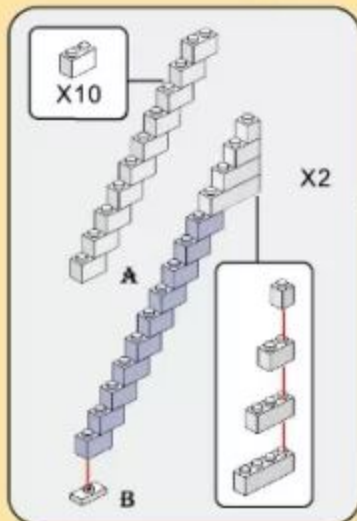

- X2 X1 (4pcs) X1
- X1 X1 (2pcs) X1

67

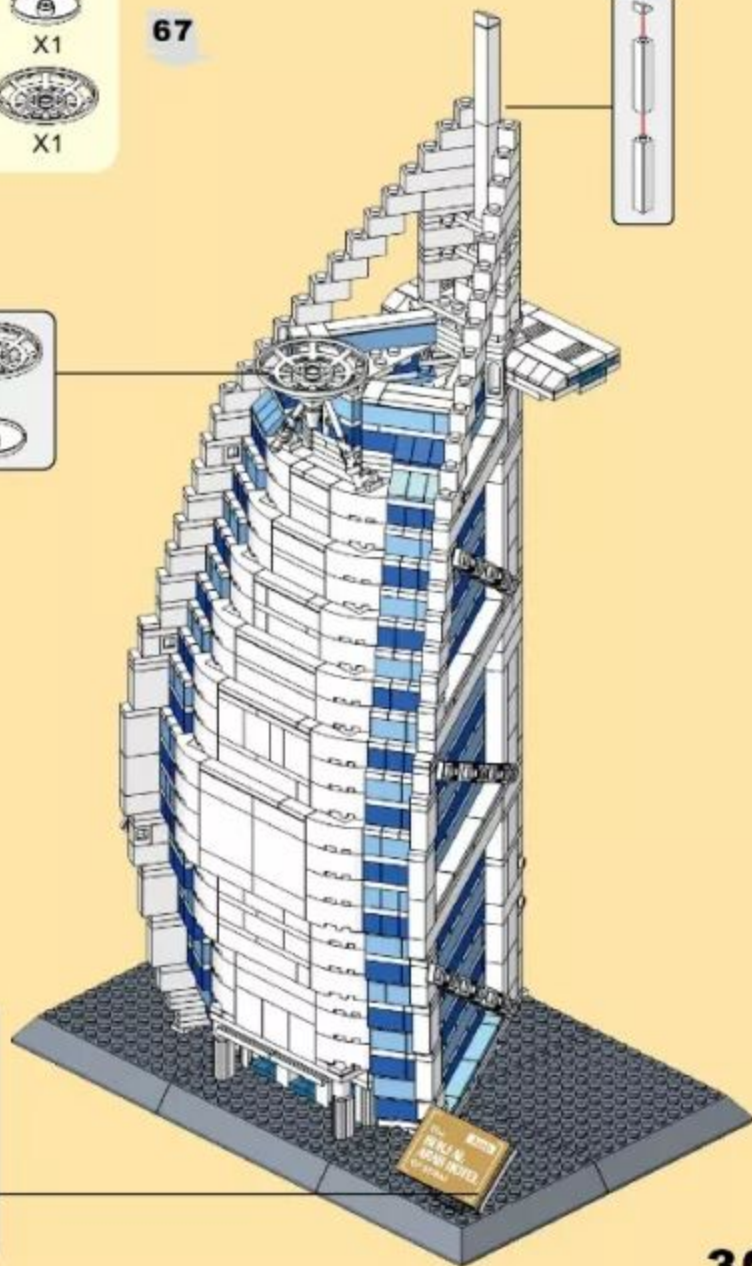



THE BURJ AL ARAB HOTEL

OF DUBAI

INTRODUCTION

DUBAI BURJ AL ARAB HOTEL, THE WORLD'S FIRST 7-STAR HOTEL, THE UNITED KINGDOM BY THE BRITISH DESIGNER TOM MUIR (TOM WRIGHT DESIGN). BUILD AN ARTIFICIAL ISLAND ON THE BEACH. A BOAT-SHAPED TOWER BUILDING, A TOTAL OF 56 FLOORS. 321 METERS HIGH. IT IS AGAINST THE JUMEIRAH BEACH HOTEL (CONSIDERED THE WORLD'S BEST HOTELS, HOTEL PRICES THROUGH A LOT OF MONEY, THE SOURCE IS STILL ACTIVE).

BURJ AL ARAB HOTEL IS THE WORLD'S HIGHEST BUILDING HEIGHT OF SEVEN-STAR HOTEL, OPENED IN DECEMBER 1999. A TOTAL OF 202 SUPERIOR ROOMS, BUILT 280 METERS AWAY FROM THE COASTLINE, THE ARTIFICIAL ISLAND ON THE JUMEIRAH BEACH RESORT. THE RESTAURANT IS MORE LUXURIOUS, PEOPLE FEEL INCREDIBLE. THE HOTELS AL-MAHARA SEAFOOD RESTAURANT IS LIKE IN THE DEEP FOR THE CUSTOMER TO CAPTURE THE FRESHEST SEAFOOD MEALS HERE ARE REALLY MEMORABLE EXPERIENCE- THE POTENTIAL TO BE USED WITHIN THE HOTEL BURJ AL ARAB WATER BOAT SHUTTLE DIRECTLY FROM THE HOTEL LOBBY STARTING AL-MAHARA SEAFOOD RESTAURANT. ALTHOUGH THE RANGE JUST THREE MINUTES, BUT HAS ENTERED A MAGICAL UNDERWATER WORLD. ALONG WITH COLORFUL TROPICAL FISH SWIMMING ON BOTH SIDES OF THE SUBMARINE TO THE SHOWGROUND. BURJ BLEND OF THE LATEST ARCHITECTURAL AND ENGINEERING TECHNOLOGY, STUNNING SCENERY AND SHAPE, IT LOOKS LIKE AND SKY BLEND. IT COST \$ 3 BILLION IN THE CONSTRUCTION OF THE EIGHTH WONDER OF THE WORLD- THE WORLD'S LARGEST ARTIFICIAL ISLAND. BY THEN. THIS DESIGN WAS SIMILAR TO THE LARGE PALM TREE ISLANDS CAN BE SEEN FROM THE MOON.

